

## GF JRG Sanipex MT cap 10 bar 26 10bar

**1158292**

- Description: to JRG Sanipex MT components
- Material: PPSU
- Connection: cone grip union

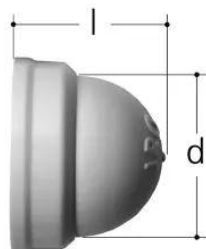

### About GF JRG Sanipex MT cap 10 bar

#### Specification

- Wide product range
- Gunmetal body

#### Application

Potable water installations

#### Certification

UK Reg4 approval

- WRAS or
- KIWA

To meet the requirements of the Water Supply (Water Fittings) Regulations 1999

## GF JRG Sanipex MT cap 10 bar 26 10bar

1158292

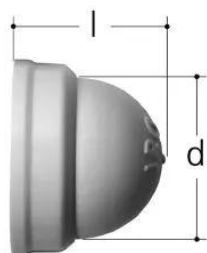

### Product code

Item no EAN	7613263029263
Item no GF	351626904
Item no GTIN	07613263029263
Item no LVI	1749082
Item no RSK	1874052

### Dimensions

Item Unit Height	25
Item Unit Length	32
Item Unit Weight	0,007
Item Unit Width	32
Item_UOM	pce

### Packaging

Packaging GTIN PL1	06414900065474
Packaging Height PL1	25
Packaging Length PL1	160
Packaging Quantity PL1	10
Packaging Type PL1	Plastic_Bag
Packaging Volume PL1	0,00026
Packaging Weight PL1	0,075
Packaging Width PL1	65

### Technical documents

Download documents here

UK

T +44 (0)1923 381212

E

customerservice.uk.bfs@georgfischer.com