

ProPEX brass ball valves

Project information

Job name:	Location:
Engineer:	Date submitted:
Contractor:	Submitted by:
Manufacturer's representative:	Approved by:

Technical data

Cold working pressure	200.2 psi
Temp/pressure ratings	73 °F (23 °C) at 160 psi (11 bar) 180 °F (82 °C) at 100 psi (6.9 bar) 200 °F (93 °C) at 80 psi (5.5 bar)
Prop 65 label required?	Yes

Product information and application use

Uponor ProPEX® Brass Ball Valve is a cost-effective alternative for radiant heating/cooling and hydronic piping applications. Both ends are manufactured with the ProPEX fitting for connections to Uponor PEX pipe. The full-port valves are compatible with propylene glycol mixtures up to 50%. Stem extensions can be installed to accommodate up to 2" of pipe insulation. Note: ProPEX Brass Ball Valves are not approved for potable-water applications.

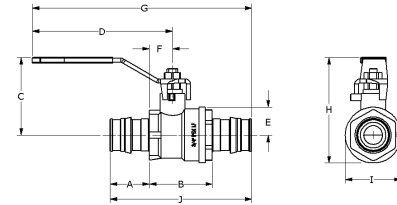

Part name	Part no.	A [inch]	B [inch]	C [inch]	D [inch]	E [inch]	F [inch]	G [inch]	H [inch]	I [inch]	J [inch]
ProPEX Brass Ball Valve 1" PEX x 1" PEX	A3201010	1.181	1.808	2.166	4.47	0.79	0.719	6.74	2.956	1.58	4.17
ProPEX Brass Ball Valve 1 1/4" PEX x 1 1/4" PEX	A3201313	1.445	1.91	2.266	4.47	0.905	0.655	7.17	3.206	1.88	4.8
ProPEX Brass Ball Valve 1 1/2" PEX x 1 1/2" PEX	A3201515	1.704	2.292	2.704	5.57	1.095	0.896	8.67	3.799	2.19	5.7
ProPEX Brass Ball Valve 2" PEX x 2" PEX	A3202020	2.147	2.834	3.374	5.57	1.467	1.103	9.448	4.831	2.915	7.128
ProPEX Brass Ball Valve 1/2" PEX x 1/2" PEX	A3205050	0.709	1.083	1.696	3.37	0.49	0.391	4.77	2.186	0.98	2.5
ProPEX Brass Ball Valve 3/4" PEX x 3/4" PEX	A3207575	0.945	1.51	1.868	3.372	0.63	0.555	5.272	2.498	1.26	3.4
2 3/8" Stem Extension Kit for 1/2" and 3/4" Valves	F5630001	-	-	-	-	-	-	-	-	-	-
2 5/8" Stem Extension Kit for 1" and 1 1/4" Valves	F5630002	-	-	-	-	-	-	-	-	-	-
2 5/8" Stem Extension Kit for 1 1/2" and 2" Valves	F5630003	-	-	-	-	-	-	-	-	-	-

Part name	Part no.	Cv	Material group	End Type 1	End Type 2	Operating voltage [V]	Weight per UOM [lbs/UOM]
ProPEX Brass Ball Valve 1" PEX x 1" PEX	A3201010	29	Brass	ProPEX 1"	ProPEX 1"	-	1.3
ProPEX Brass Ball Valve 1 1/4" PEX x 1 1/4" PEX	A3201313	54.7	Brass	ProPEX 1-1/4"	ProPEX 1-1/4"	-	1.44
ProPEX Brass Ball Valve 1 1/2" PEX x 1 1/2" PEX	A3201515	68.2	Brass	ProPEX 1-1/2"	ProPEX 1-1/2"	-	2.12
ProPEX Brass Ball Valve 2" PEX x 2" PEX	A3202020	132.2	Brass	ProPEX 2"	ProPEX 2"	-	4.18
ProPEX Brass Ball Valve 1/2" PEX x 1/2" PEX	A3205050	7	Brass	ProPEX 1/2"	ProPEX 1/2"	30	0.36
ProPEX Brass Ball Valve 3/4" PEX x 3/4" PEX	A3207575	18	Brass	ProPEX 3/4"	ProPEX 3/4"	-	0.52
2 3/8" Stem Extension Kit for 1/2" and 3/4" Valves	F5630001	-	Brass	-	-	-	0.31
2 5/8" Stem Extension Kit for 1" and 1 1/4" Valves	F5630002	-	Brass	-	-	-	0.48
2 5/8" Stem Extension Kit for 1 1/2" and 2" Valves	F5630003	-	LF Brass	-	-	-	0.57

Part name	Part no.	Codes	Standards	Listings
ProPEX brass ball valves	All	-	-	-
In addition, the following parts have additional codes, standards, or listings:				
ProPEX Brass Ball Valve 1" PEX x 1" PEX	A3201010	IMC UMC	ASTM F1960 CSA B137.5 NSF-14 ASTM F877 NSF-359	cNSFus-rfh
ProPEX Brass Ball Valve 1 1/4" PEX x 1 1/4" PEX	A3201313	IMC UMC	ASTM F1960 CSA B137.5 NSF-14 ASTM F877 NSF-359	cNSFus-rfh
ProPEX Brass Ball Valve 1 1/2" PEX x 1 1/2" PEX	A3201515	IMC UMC	ASTM F1960 CSA B137.5 NSF-14 ASTM F877 NSF-359	cNSFus-rfh
ProPEX Brass Ball Valve 2" PEX x 2" PEX	A3202020	IMC UMC	ASTM F1960 CSA B137.5 NSF-14 ASTM F877 NSF-359	cNSFus-rfh
ProPEX Brass Ball Valve 1/2" PEX x 1/2" PEX	A3205050	IMC UMC	ASTM F1960 CSA B137.5 NSF-14 ASTM F877 NSF-359	cNSFus-rfh
ProPEX Brass Ball Valve 3/4" PEX x 3/4" PEX	A3207575	IMC UMC	ASTM F1960 CSA B137.5 NSF-14 ASTM F877 NSF-359	cNSFus-rfh
2 3/8" Stem Extension Kit for 1/2" and 3/4" Valves	F5630001	IMC UMC	ASTM F1960 CSA B137.5 NSF-14 ASTM F877 NSF-359	cNSFus-rfh
2 5/8" Stem Extension Kit for 1" and 1 1/4" Valves	F5630002	IMC UMC	ASTM F1960 CSA B137.5 NSF-14 ASTM F877 NSF-359	cNSFus-rfh

Installation	Related applications
<p>Install valve according to local building code. Do not dismantle. Refer to the Uponor Hydronic Piping Design Assistance Manual (HPDAM) or the Uponor Radiant Floor Heating Installation Handbook for additional information.</p>	<ul style="list-style-type: none"> Hot water distribution Hydronic heating and cooling systems Hydronic Piping Systems Hydronic Radiant Heating and Cooling Systems PEX-a Plumbing Systems Plumbing Systems Pre-Insulated Pipe Systems Radiant Floor Heating and Cooling Systems Radiant Heating and Cooling Systems

Footnotes	Contact information		
-	<table border="0"> <tr> <td style="text-align: center;"> <p>Uponor Inc. 5925 148th Street West Apple Valley, MN 55124 T 800.321.4739 F 952.891.2008</p> </td> <td style="text-align: center;"> <p>Uponor Ltd. 6510 Kennedy Road Mississauga, ON L5T 2X4 T 888.594.7726 F 800.638.9517</p> </td> </tr> </table>	<p>Uponor Inc. 5925 148th Street West Apple Valley, MN 55124 T 800.321.4739 F 952.891.2008</p>	<p>Uponor Ltd. 6510 Kennedy Road Mississauga, ON L5T 2X4 T 888.594.7726 F 800.638.9517</p>
<p>Uponor Inc. 5925 148th Street West Apple Valley, MN 55124 T 800.321.4739 F 952.891.2008</p>	<p>Uponor Ltd. 6510 Kennedy Road Mississauga, ON L5T 2X4 T 888.594.7726 F 800.638.9517</p>		