

ProPEX lead-free (LF) brass CPVC socket adapters

Project information

| | |
|--------------------------------|-----------------|
| Job name: | Location: |
| Engineer: | Date submitted: |
| Contractor: | Submitted by: |
| Manufacturer's representative: | Approved by: |

Technical data

| | |
|-------------------------|--|
| Material | LF Brass |
| Subcomponent Material | Body: LF Brass and CPVC O-ring: EPDM |
| Temp/pressure ratings | 73 °F (23 °C) at 160 psi (11 bar) 180 °F (82 °C) at 100 psi (6.9 bar) 200 °F (93 °C) at 80 psi (5.5 bar) |
| Prop 65 label required? | Yes |

Product information and application use

ProPEX® Lead-free (LF) Brass CPVC Socket Adapters transition Uponor PEX tubing to CPVC copper tube size (CTS) pipe for use in hot and cold domestic potable water systems and hydronic radiant heating and cooling systems.

Note: Temperature and pressure ratings stated are hydrostatic ratings. For domestic hot-water (DHW) and DHW recirculation installations, operating conditions should not exceed 140°F (60°C) at 80 psi (5.5 bar) in accordance with ASTM F2023. For additional information regarding application-specific temperature and pressure ratings, refer to the Uponor PEX Piping Systems Design and Installation Manual.

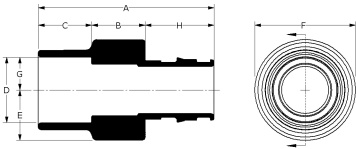

| Part name | Part no. | A [inch] | B [inch] | C [inch] | D [inch] | E [inch] | F [inch] | G [inch] | H [inch] | End Type 1 | End Type 2 |
|---|-----------|-------------|-------------|-------------|-------------|-------------|-------------|-------------|-------------|------------------|------------------|
| ProPEX LF Brass x CPVC Socket Adapter, 1 1/4" PEX x 1 1/4" CPVC (CTS) | CP4511313 | 3.685 | 1.12 | 1.12 | 1.385 | 1.055 | 2.11 | 0.693 | 1.445 | ProPEX 1-1/4" | CPVC 1-1/4" |
| ProPEX LF Brass x CPVC Socket Adapter, 1 1/2" PEX x 1 1/2" CPVC (CTS) | CP4511515 | 4.184 | 1.16 | 1.32 | 1.64 | 1.2 | 2.4 | 0.82 | 1.704 | ProPEX 1-1/2" | CPVC 1-1/2" |
| ProPEX LF Brass x CPVC Socket Adapter, 2" PEX x 2" CPVC (CTS) | CP4512020 | 5.227 | 1.36 | 1.72 | 2.141 | 1.5 | 3.0 | 1.07 | 2.147 | ProPEX 2" | CPVC 2" |

| Part name | Part no. | Weight per UOM [lbs/UOM] |
|---|-----------|--------------------------|
| ProPEX LF Brass x CPVC Socket Adapter, 1 1/4" PEX x 1 1/4" CPVC (CTS) | CP4511313 | 0.62 |
| ProPEX LF Brass x CPVC Socket Adapter, 1 1/2" PEX x 1 1/2" CPVC (CTS) | CP4511515 | 0.77 |
| ProPEX LF Brass x CPVC Socket Adapter, 2" PEX x 2" CPVC (CTS) | CP4512020 | 1.42 |

| Part name | Part no. | Codes | Standards | Listings |
|--|----------|---|--|---|
| ProPEX lead-free (LF) brass CPVC socket adapters | All | UPC IBC IRC IPC NPC of Canada UMC NSPC IMC | NSF-372 ASTM F877 ASTM F1960 CSA B137.5 ASTM D2846 NSF-61 NSF-14 | IAPMO-ES HUD MR 1269 ICC-ES- PMG cNSFus-pw-G U.P.Code cQAlus P321 |

Installation

Use the appropriate Uponor ProPEX Ring for the tubing (sold separately). Refer to the Uponor AquaPEX® Professional Plumbing Installation Guide or Uponor Radiant Floor Heating Installation Handbook for additional information. Follow all CPVC instructions and guidelines for proper CPVC connections.

Related applications

- PEX-a Plumbing Systems
- Radiant Heating and Cooling Systems
- Permafrost Protection Systems
- Turf Conditioning Systems

Footnotes

-

Contact information

Uponor Inc.
5925 148th Street West
Apple Valley, MN 55124
T 800.321.4739
F 952.891.2008

Uponor Ltd.
6510 Kennedy Road
Mississauga, ON L5T 2X4
T 888.594.7726
F 800.638.9517