

ProPEX lead-free (LF) copper tub ells

Project information

| | |
|--------------------------------|-----------------|
| Job name: | Location: |
| Engineer: | Date submitted: |
| Contractor: | Submitted by: |
| Manufacturer's representative: | Approved by: |

Technical data

| | |
|-------------------------|-------------------------------------|
| Material | Copper |
| Subcomponent Material | LF Brass |
| | Copper |
| Temp/pressure ratings | 73 °F (23 °C) at 160 psi (11 bar) |
| | 180 °F (82 °C) at 100 psi (6.9 bar) |
| | 200 °F (93 °C) at 80 psi (5.5 bar) |
| Prop 65 label required? | Yes |

Product information and application use

The ProPEX® Copper Tub Ell, 1/2" PEX Lead-free (LF) Brass x 1/2" Copper is available for use in hot and cold domestic potable water systems. The copper tub ell is comprised of 1/2" copper pipe with an Uponor ProPEX Fitting on one end and the other end open

Note: Temperature and pressure ratings stated are hydrostatic ratings. For domestic hot-water (DHW) and DHW recirculation installations, operating conditions should not exceed 140°F (60°C) at 80 psi (5.5 bar) in accordance with ASTM F2023. For additional information regarding application-specific temperature and pressure ratings, refer to the Uponor PEX Piping Systems Design and Installation Manual.

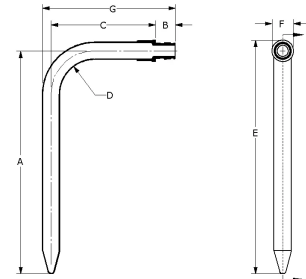

| Part name | Part no. | A [inch] | B [inch] | C [inch] | D [inch] | E [inch] | F [inch] | G [inch] | End Type 1 | Weight per UOM [lbs/UOM] |
|--|-----------|-------------|-------------|-------------|-------------|-------------|-------------|-------------|------------------|--------------------------------|
| ProPEX LF Copper Stub Ell, 1/2" PEX LF Brass x 1/2" Copper (3 1/2" x 8") | LF2865050 | 7.987 | 0.709 | 3.749 | 3.084 | 8.372 | 0.77 | 4.77 | ProPEX 1/2" | 0.2 |
| ProPEX LF Copper Tub Ell, 1/2" PEX LF Brass x 1/2" Copper (3" x 6") | LF2875050 | 2.989 | 0.709 | 5.279 | 1.542 | 3.374 | 0.77 | 6.3 | ProPEX 1/2" | 0.23 |
| ProPEX LF Copper Stub Ell, 1/2" PEX LF Brass x 1/2" Copper (13" x 8") | LF2855050 | 7.987 | 0.709 | 12.299 | 3.084 | 8.372 | 0.77 | 13.32 | ProPEX 1/2" | 0.5 |
| ProPEX LF Copper Tub Ell, 1/2" PEX LF Brass x 1/2" Copper (3" x 4") | LF2885050 | 2.989 | 0.709 | 3.279 | 1.542 | 3.374 | 0.77 | 4.3 | ProPEX 1/2" | 0.2 |
| ProPEX LF Copper Stub Ell, 1/2" PEX LF Brass x 1/2" Copper (8" x 13") | LF2895050 | 12.985 | 0.709 | 7.295 | 3.04 | 13.37 | 0.77 | 8.316 | ProPEX 1/2" | 0.48 |
| ProPEX LF Copper Stub Ell, 3/4" PEX LF Brass x 3/4" Copper (4" x 8") | LF2897575 | 8.002 | 0.945 | 4.057 | 3.959 | 8.552 | 1.1 | 5.44 | ProPEX 3/4" | 0.5 |
| ProPEX LF Copper Stub Ell, 1" PEX x 1" Copper (13" x 8") | LF2891010 | 13 | 1.181 | 6.507 | 8 | 13.68 | 1.36 | 8.25 | ProPEX 1" | 1.7 |

| Part name | Part no. | Codes | Standards | Listings |
|---------------------------------------|----------|---|---|----------------------|
| ProPEX lead-free (LF) copper tub ells | All | UPC IBC IRC IPC NPC of Canada UMC NSPC IMC | NSF/ANSI/CAN 372 ASTM F877 ASTM F1960 CSA B137.5 NSF/ANSI/CAN 61 NSF/ANSI 14 | IAPMO-ES HUD MR 1269 |

In addition, the following parts have additional codes, standards, or listings:

| | |
|--|-----------|
| ProPEX LF Copper Stub Ell, 1/2" PEX LF Brass x 1/2" Copper (3 1/2" x 8") | LF2865050 |
| ProPEX LF Copper Stub Ell, 1/2" PEX LF Brass x 1/2" Copper (8" x 13") | LF2895050 |
| ProPEX LF Copper Stub Ell, 3/4" PEX LF Brass x 3/4" Copper (4" x 8") | LF2897575 |
| ProPEX LF Copper Stub Ell, 1" PEX x 1" Copper (13" x 8") | LF2891010 |

Installation

Use compression fitting with a male national pipe thread (MNPT) adapter. Refer to the AquaPEX® Professional Plumbing Installation Guide for additional information.

Related applications

- PEX-a Plumbing Systems
- Radiant Heating and Cooling Systems
- Permafrost Protection Systems
- Turf Conditioning Systems

| Footnotes | | Contact information | |
|-----------|--|------------------------|-------------------------|
| - | | Uponor Inc. | Uponor Ltd. |
| | | 5925 148th Street West | 6510 Kennedy Road |
| | | Apple Valley, MN 55124 | Mississauga, ON L5T 2X4 |
| | | T 800.321.4739 | T 888.594.7726 |
| | | F 952.891.2008 | F 800.638.9517 |