

ProPEX lead-free (LF) brass commercial ball valves

Project information

| | |
|--------------------------------|-----------------|
| Job name: | Location: |
| Engineer: | Date submitted: |
| Contractor: | Submitted by: |
| Manufacturer's representative: | Approved by: |

Technical data

| | |
|-------------------------|--------------------------------------|
| Cold working pressure | 250 psi |
| Temp/pressure ratings | 200 °F (93 °C) at 200 psi (13.8 bar) |
| Prop 65 label required? | Yes |

Product information and application use

To help meet the stringent demands of commercial plumbing and hydronic distribution projects, Uponor is offering new ProPEX® ASTM F1960 lead-free (LF) brass ball valves in sizes from ½" to 2". The full-port ball valves feature a stainless-steel ball and stem for greater durability, longevity, and system performance.

Note: Temperature and pressure ratings stated are hydrostatic ratings. For domestic hot-water (DHW) and DHW recirculation installations, operating conditions should not exceed 140°F (60°C) at 80 psi (5.5 bar) in accordance with ASTM F2023. For additional information regarding application-specific temperature and pressure ratings, refer to the Uponor PEX Piping Systems Design and Installation Manual.

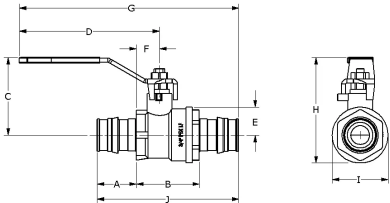

| Part name | Part no. | A [inch] | B [inch] | C [inch] | D [inch] | E [inch] | F [inch] | G [inch] | H [inch] | I [inch] | J [inch] |
|---|--------------|-------------|-------------|-------------|-------------|-------------|-------------|-------------|-------------|-------------|-------------|
| ProPEX LF Brass Commercial Ball Valve (full port) SS Ball and Stem 1/2" PEX x 1/2" PEX | LFC4825050SS | 0.709 | 1.228 | 1.679 | 3.37 | 0.447 | 0.465 | 4.843 | 2.126 | 0.959 | 2.646 |
| ProPEX LF Brass Commercial Ball Valve (full port) SS Ball and Stem 3/4" PEX x 3/4" PEX | LFC4827575SS | 0.945 | 1.358 | 1.789 | 3.37 | 0.634 | 0.522 | 5.151 | 2.423 | 1.268 | 3.248 |
| ProPEX LF Brass Commercial Ball Valve (full port) SS Ball and Stem 1" PEX x 1" PEX | LFC4821010SS | 1.181 | 1.618 | 2.181 | 4.52 | 0.748 | 0.685 | 6.504 | 2.181 | 1.496 | 3.98 |
| ProPEX LF Brass Commercial Ball Valve (full port) SS Ball and Stem 1 1/4" PEX x 1 1/4" PEX | LFC4821313SS | 1.445 | 1.862 | 2.388 | 4.516 | 0.915 | 0.821 | 7.002 | 3.303 | 1.831 | 4.752 |
| ProPEX LF Brass Commercial Ball Valve (full port) SS Ball and Stem 1 1/2" PEX x 1 1/2" PEX | LFC4821515SS | 1.705 | 2.059 | 3.114 | 5.584 | 1.024 | 0.98 | 8.368 | 4.138 | 2.087 | 5.469 |
| ProPEX LF Brass Commercial Ball Valve (full port) SS Ball and Stem 2" PEX x 2" PEX | LFC4822020SS | 2.146 | 2.413 | 3.339 | 5.584 | 1.358 | 1.122 | 9.021 | 4.697 | 2.638 | 6.705 |

| Part name | Part no. | Cv | End Type 1 | End Type 2 | Weight per UOM [lbs/UOM] |
|---|--------------|-------|---------------|---------------|-----------------------------|
| ProPEX LF Brass Commercial Ball Valve (full port) SS Ball and Stem 1/2" PEX x 1/2" PEX | LFC4825050SS | 6.8 | ProPEX 1/2" | ProPEX 1/2" | 0.33 |
| ProPEX LF Brass Commercial Ball Valve (full port) SS Ball and Stem 3/4" PEX x 3/4" PEX | LFC4827575SS | 17 | ProPEX 3/4" | ProPEX 3/4" | 0.45 |
| ProPEX LF Brass Commercial Ball Valve (full port) SS Ball and Stem 1" PEX x 1" PEX | LFC4821010SS | 29 | ProPEX 1" | ProPEX 1" | 0.87 |
| ProPEX LF Brass Commercial Ball Valve (full port) SS Ball and Stem 1 1/4" PEX x 1 1/4" PEX | LFC4821313SS | 49.1 | ProPEX 1-1/4" | ProPEX 1-1/4" | 1.29 |
| ProPEX LF Brass Commercial Ball Valve (full port) SS Ball and Stem 1 1/2" PEX x 1 1/2" PEX | LFC4821515SS | 58.9 | ProPEX 1-1/2" | ProPEX 1-1/2" | 1.9 |
| ProPEX LF Brass Commercial Ball Valve (full port) SS Ball and Stem 2" PEX x 2" PEX | LFC4822020SS | 139.1 | ProPEX 2" | ProPEX 2" | 2.97 |

| Part name | Part no. | Codes | Standards | Listings |
|--|--------------|---|---|----------------------|
| ProPEX lead-free (LF) brass commercial ball valves | All | UPC IBC IRC IPC NPC of Canada UMC IMC | ASTM F877 NSF/ANSI/CAN 372 NSF/ANSI 359 ASTM F1960 CSA B137.5 NSF/ANSI/CAN 61 NSF/ANSI 14 | cNSFus-pw-G U.P.Code |
| In addition, the following parts have additional codes, standards, or listings: | | | | |
| ProPEX LF Brass Commercial Ball Valve (full port) SS Ball and Stem 1/2" PEX x 1/2" PEX | LFC4825050SS | | | |
| ProPEX LF Brass Commercial Ball Valve (full port) SS Ball and Stem 3/4" PEX x 3/4" PEX | LFC4827575SS | | | |
| ProPEX LF Brass Commercial Ball Valve (full port) SS Ball and Stem 1 1/4" PEX x 1 1/4" PEX | LFC4821313SS | | | |
| Installation | | Related applications | | |
| Install valve and stem extension kit according to local building code. Do not dismantle. Refer to the Uponor Piping Pocket Guide or the Uponor PEX Piping Systems Design and Installation Manual for additional information. | | Hot water distribution | | |
| | | Hydronic heating and cooling systems | | |
| | | Hydronic Piping Systems | | |
| | | Hydronic Radiant Heating and Cooling Systems | | |
| | | PEX-a Plumbing Systems | | |
| | | Plumbing Systems | | |
| | | Pre-Insulated Pipe Systems | | |
| | | Radiant Heating and Cooling Systems | | |
| Footnotes | | Contact information | | |
| - | | Uponor Inc. 5925 148th Street West Apple Valley, MN 55124 T 800.321.4739 F 952.891.2008 | Uponor Ltd. 6510 Kennedy Road Mississauga, ON L5T 2X4 T 888.594.7726 F 800.638.9517 | |