

ProPEX lead-free (LF) brass residential ball valves

Project information

Job name:	Location:
Engineer:	Date submitted:
Contractor:	Submitted by:
Manufacturer's representative:	Approved by:

Technical data

Temp/pressure ratings200 °F (93 °C) at 200 psi (13.8 bar)

Product information and application use

To help meet the stringent demands of residential plumbing and hydronic distribution projects, Uponor is offering new ProPEX® ASTM F1960 lead-free (LF) brass ball valves in sizes from ½" to 1". The full-port ball valves feature a chrome-plated ball.

Note: Temperature and pressure ratings stated are hydrostatic ratings. For domestic hot-water (DHW) and DHW recirculation installations, operating conditions should not exceed 140°F (60°C) at 80 psi (5.5 bar) in accordance with ASTM F2023. For additional information regarding application-specific temperature and pressure ratings, refer to the Uponor PEX Piping Systems Design and Installation Manual.

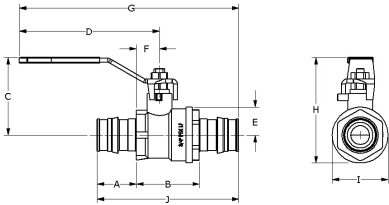

Part name	Part no.	A [inch]	B [inch]	C [inch]	D [inch]	E [inch]	F [inch]	G [inch]	H [inch]	I [inch]	J [inch]
ProPEX LF Brass Stop and Drain Ball Valve (full port), 1" PEX x 1" PEX	LFD4811010	1.181	1.862	1.978	4.227	0.746	0.909	6.361	2.724	2.022	4.224
ProPEX LF Brass Stop and Drain Ball Valve (full port), 1/2" PEX x 1/2" PEX	LFD4815050	0.709	1.449	2.867	3.681	1.624	0.725	5.114	2.071	1.437	2.867
ProPEX LF Brass Stop and Drain Ball Valve (full port), 3/4" PEX x 3/4" PEX	LFD4817575	0.945	1.657	1.841	4.241	0.602	0.803	6.04	2.443	1.726	3.548
ProPEX LF Brass Ball Valve (full port), 1" PEX x 1" PEX	LFR4811010	1.181	1.618	2.208	4.503	0.746	0.685	6.617	2.954	1.492	3.98
ProPEX LF Brass Ball Valve (full port), 1/2" PEX x 1/2" PEX	LFR4815050	0.709	1.228	1.647	3.361	0.447	0.465	4.834	2.094	0.939	2.646
ProPEX LF Brass Ball Valve (full port), 3/4" PEX x 3/4" PEX	LFR4817575	0.945	1.357	1.796	3.361	0.634	0.522	5.142	2.43	1.268	3.247

Part name	Part no.	Cv	End Type 1	End Type 2	Material group	Prop 65 label required?	Weight per UOM [lbs/UOM]
ProPEX LF Brass Stop and Drain Ball Valve (full port), 1" PEX x 1" PEX	LFD4811010	31.7	ProPEX 1"	ProPEX 1"	-	-	0.9
ProPEX LF Brass Stop and Drain Ball Valve (full port), 1/2" PEX x 1/2" PEX	LFD4815050	6.5	ProPEX 1/2"	ProPEX 1/2"	-	-	0.35
ProPEX LF Brass Stop and Drain Ball Valve (full port), 3/4" PEX x 3/4" PEX	LFD4817575	16.6	ProPEX 3/4"	ProPEX 3/4"	-	-	0.6
ProPEX LF Brass Ball Valve (full port), 1" PEX x 1" PEX	LFR4811010	31.4	ProPEX 1"	ProPEX 1"	-	-	0.88
ProPEX LF Brass Ball Valve (full port), 1/2" PEX x 1/2" PEX	LFR4815050	6.7	ProPEX 1/2"	ProPEX 1/2"	LF Brass	-	0.34
ProPEX LF Brass Ball Valve (full port), 3/4" PEX x 3/4" PEX	LFR4817575	15.8	ProPEX 3/4"	ProPEX 3/4"	-	Yes	0.5

Part name	Part no.	Codes	Standards	Listings
ProPEX lead-free (LF) brass residential ball valves	All	UPC IBC IRC IPC NPC of Canada UMC IMC	NSF-372 ASTM F877 NSF-359 ASTM F1960 CSA B137.5 NSF-61 NSF-14	cNSFus-pw-G U.P.Code

Installation	Related applications
Install valve and stem extension kit according to local building code. Do not dismantle. Refer to the Uponor Piping Pocket Guide or the Uponor Plumbing Design Assistance Manual (PDAM) for additional information.	Hot water distribution
	Hydronic heating and cooling systems
	Hydronic Piping Systems
	Hydronic Radiant Heating and Cooling Systems
	PEX-a Plumbing Systems
	Plumbing Systems
	Pre-Insulated Pipe Systems
	Radiant Heating and Cooling Systems

Footnotes	Contact information	
-	Uponor Inc. 5925 148th Street West Apple Valley, MN 55124 T 800.321.4739 F 952.891.2008	Uponor Ltd. 6510 Kennedy Road Mississauga, ON L5T 2X4 T 888.594.7726 F 800.638.9517