

ProPEX lead-free (LF) brass residential ball valves

Project information

| | |
|--------------------------------|-----------------|
| Job name: | Location: |
| Engineer: | Date submitted: |
| Contractor: | Submitted by: |
| Manufacturer's representative: | Approved by: |

Technical data

| | |
|-------------------------|--------------------------------------|
| Material | LF Brass |
| Temp/pressure ratings | 200 °F (93 °C) at 200 psi (13.8 bar) |
| Prop 65 label required? | Yes |

Product information and application use

To help meet the stringent demands of residential plumbing and hydronic distribution projects, Uponor is offering new ProPEX® ASTM F1960 lead-free (LF) brass ball valves in sizes from ½" to 1". The full-port ball valves feature a chrome-plated ball.

Note: Temperature and pressure ratings stated are hydrostatic ratings. For domestic hot-water (DHW) and DHW recirculation installations, operating conditions should not exceed 140°F (60°C) at 80 psi (5.5 bar) in accordance with ASTM F2023. For additional information regarding application-specific temperature and pressure ratings, refer to the Uponor PEX Piping Systems Design and Installation Manual.

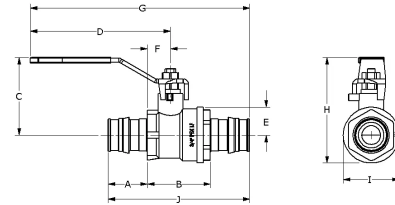

| Part name | Part no. | A [inch] | B [inch] | C [inch] | D [inch] | E [inch] | F [inch] | G [inch] | H [inch] | I [inch] | J [inch] |
|--|------------|----------|----------|----------|----------|----------|----------|----------|----------|----------|----------|
| ProPEX LF Brass Stop and Drain Ball Valve (full port), 1" PEX x 1" PEX | LFD4811010 | 1.181 | 1.65 | 2.043 | 4.503 | 0.689 | 0.846 | 6.487 | 2.731 | 2.134 | 4.012 |
| ProPEX LF Brass Stop and Drain Ball Valve (full port), 1/2" PEX x 1/2" PEX | LFD4815050 | 0.709 | 1.24 | 1.44 | 3.361 | 0.394 | 0.63 | 4.68 | 1.834 | 1.459 | 2.657 |
| ProPEX LF Brass Stop and Drain Ball Valve (full port), 3/4" PEX x 3/4" PEX | LFD4817575 | 0.945 | 1.398 | 1.621 | 2.784 | 0.531 | 0.65 | 4.976 | 2.153 | 1.839 | 3.287 |
| ProPEX LF Brass Ball Valve (full port), 1" PEX x 1" PEX | LFR4811010 | 1.181 | 1.374 | 2.043 | 4.503 | 0.689 | 0.571 | 6.487 | 2.731 | 1.772 | 3.736 |
| ProPEX LF Brass Ball Valve (full port), 1/2" PEX x 1/2" PEX | LFR4815050 | 0.709 | 1.004 | 1.44 | 3.361 | 0.394 | 0.394 | 4.68 | 1.834 | 1.012 | 2.421 |
| ProPEX LF Brass Ball Valve (full port), 3/4" PEX x 3/4" PEX | LFR4817575 | 0.945 | 1.13 | 1.621 | 3.348 | 0.531 | 0.447 | 4.976 | 2.153 | 1.339 | 3.02 |

| Part name | Part no. | Cv | End Type 1 | End Type 2 | Weight per UOM [lbs/UOM] |
|--|------------|------|-------------|-------------|--------------------------|
| ProPEX LF Brass Stop and Drain Ball Valve (full port), 1" PEX x 1" PEX | LFD4811010 | 25.2 | ProPEX 1" | ProPEX 1" | 0.78 |
| ProPEX LF Brass Stop and Drain Ball Valve (full port), 1/2" PEX x 1/2" PEX | LFD4815050 | 5.7 | ProPEX 1/2" | ProPEX 1/2" | 0.3 |
| ProPEX LF Brass Stop and Drain Ball Valve (full port), 3/4" PEX x 3/4" PEX | LFD4817575 | 11.1 | ProPEX 3/4" | ProPEX 3/4" | 0.45 |
| ProPEX LF Brass Ball Valve (full port), 1" PEX x 1" PEX | LFR4811010 | 21.8 | ProPEX 1" | ProPEX 1" | 0.67 |
| ProPEX LF Brass Ball Valve (full port), 1/2" PEX x 1/2" PEX | LFR4815050 | 4.6 | ProPEX 1/2" | ProPEX 1/2" | 0.26 |
| ProPEX LF Brass Ball Valve (full port), 3/4" PEX x 3/4" PEX | LFR4817575 | 10.1 | ProPEX 3/4" | ProPEX 3/4" | 0.39 |

| Part name | Part no. | Codes | Standards | Listings |
|---|----------|---------------------------------------|---|----------------------|
| ProPEX lead-free (LF) brass residential ball valves | All | UPC IBC IRC IPC NPC of Canada UMC IMC | NSF ANSI CAN 372 ASTM F877 NSF ANSI 359 ASTM F1960 CSA B137.5 NSF ANSI CAN 61 NSF ANSI 14 | cNSFus-pw-G U.P.Code |

In addition, the following parts have additional codes, standards, or listings:

| | |
|--|------------|
| ProPEX LF Brass Stop and Drain Ball Valve (full port), 1/2" PEX x 1/2" PEX | LFD4815050 |
| ProPEX LF Brass Stop and Drain Ball Valve (full port), 3/4" PEX x 3/4" PEX | LFD4817575 |
| ProPEX LF Brass Ball Valve (full port), 1" PEX x 1" PEX | LFR4811010 |
| ProPEX LF Brass Ball Valve (full port), 1/2" PEX x 1/2" PEX | LFR4815050 |

| Installation | Related applications |
|--|---|
| <p>Install valve and stem extension kit according to local building code. Do not dismantle. Refer to the Uponor Piping Pocket Guide or the Uponor Plumbing Design Assistance Manual (PDAM) for additional information.</p> | <p>Hot water distribution Hydronic heating and cooling systems Hydronic Piping Systems Hydronic Radiant Heating and Cooling Systems PEX-a Plumbing Systems Plumbing Systems Pre-Insulated Pipe Systems Radiant Heating and Cooling Systems</p> |

| Footnotes | Contact information | |
|-----------|--|--|
| - | <p>Uponor Inc. 5925 148th Street West Apple Valley, MN 55124 T 800.321.4739 F 952.891.2008</p> | <p>Uponor Ltd. 6510 Kennedy Road Mississauga, ON L5T 2X4 T 888.594.7726 F 800.638.9517</p> |