

Uponor lead-free (LF) brass female threaded adapters (socket fusion)



Project Information

Job name:	Location:
Engineer:	Date submitted:
Contractor:	Submitted by:
Manufacturer's representative:	Approved by:

Technical data

Material	PP-RCT
Prop 65 label required?	Yes

Product information and application use

Use Uponor lead-free (LF) brass female threaded adapters with Uponor PP-RCT mechanical or cold potable pipe to convey water for hydronic heating and cooling or potable plumbing applications.

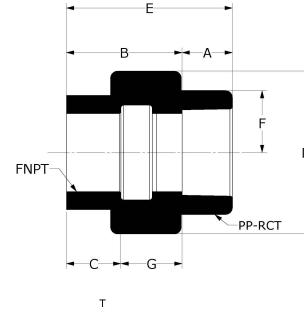

Part name	Part no.	A [inch]	B [inch]	C [inch]	D [inch]	E [inch]	F [inch]	G [inch]	Weight per UOM [lbs/UOM]	Equivalent length through [ft]	End Type 1
Uponor LF Brass Female Threaded Adapter, 1" PP-RCT x 1" NPT	PR4571010	0.713	1.039	0.69	2.307	1.752	0.856	0.349	0.32	1.7	Socket 1"
Uponor LF Brass Female Threaded Adapter, 1" PP-RCT x 3/4" NPT	PR4571075	0.776	0.827	0.55	1.906	1.602	0.846	0.277	0.19	1.4	Socket 1"
Uponor LF Brass Female Threaded Adapter, 1 1/4" PP-RCT x 1" NPT	PR4571310	0.835	1.008	0.69	2.756	1.843	1.083	0.318	0.4	1.7	Socket 1-1/4"
Uponor LF Brass Female Threaded Adapter, 1 1/4" PP-RCT x 1 1/4" NPT	PR4571313	0.807	1.634	0.71	2.795	2.441	1.073	0.53	0.54	2.2	Socket 1-1/4"
Uponor LF Brass Female Threaded Adapter, 1 1/2" PP-RCT x 1 1/2" NPT	PR4571515	0.925	1.378	0.72	3.228	2.303	1.333	0.658	0.81	2.7	Socket 1-1/2"
Uponor LF Brass Female Threaded Adapter, 2" PP-RCT x 2" NPT	PR4572020	1.079	1.51	0.76	3.839	2.589	1.634	0.75	1.11	3.4	Socket 2"
Uponor LF Brass Female Threaded Adapter, 1/2" PP-RCT x 1/2" NPT	PR4575050	0.571	0.905	0.54	1.417	1.476	0.537	0.365	0.11	1.1	Socket 1/2"
Uponor LF Brass Female Threaded Adapter, 1/2" PP-RCT x 3/4" NPT	PR4575075	0.575	0.764	0.55	1.701	1.339	0.545	0.214	0.15	1.4	Socket 1/2"
Uponor LF Brass Female Threaded Adapter, 3/4" PP-RCT x 1/2" NPT	PR4577550	0.63	0.827	0.54	1.374	1.457	0.677	0.287	0.14	1.1	Socket 3/4"
Uponor LF Brass Female Threaded Adapter, 3/4" PP-RCT x 3/4" NPT	PR4577575	0.63	0.882	0.55	1.61	1.512	0.673	0.332	0.15	1.4	Socket 3/4"

Part name	Part no.	End Type 2	Operating Temperature 1 [°F]	Operating Temperature 2 [°F]	Operating Temperature 3 [°F]
Uponor LF Brass Female Threaded Adapter, 1" PP-RCT x 1" NPT	PR4571010	FNPT 1"	73 °F (23 °C) at 270 psi (23 °C)	120 °F (49 °C) at 176 psi (49 °C)	180 °F (82 °C) at 120 psi (82 °C)
Uponor LF Brass Female Threaded Adapter, 1" PP-RCT x 3/4" NPT	PR4571075	FNPT 3/4"	73 °F (23 °C) at 340 psi (23 °C)	140 °F (49 °C) at 190 psi (49 °C)	180 °F (82 °C) at 100 psi (82 °C)
Uponor LF Brass Female Threaded Adapter, 1 1/4" PP-RCT x 1" NPT	PR4571310	FNPT 1"	73 °F (23 °C) at 340 psi (23 °C)	140 °F (49 °C) at 190 psi (49 °C)	180 °F (82 °C) at 100 psi (82 °C)
Uponor LF Brass Female Threaded Adapter, 1 1/4" PP-RCT x 1 1/4" NPT	PR4571313	FNPT 1-1/4"	73 °F (23 °C) at 270 psi (23 °C)	120 °F (49 °C) at 176 psi (49 °C)	180 °F (82 °C) at 120 psi (82 °C)
Uponor LF Brass Female Threaded Adapter, 1 1/2" PP-RCT x 1 1/2" NPT	PR4571515	FNPT 1-1/2"	73 °F (23 °C) at 270 psi (23 °C)	120 °F (49 °C) at 176 psi (49 °C)	180 °F (82 °C) at 120 psi (82 °C)
Uponor LF Brass Female Threaded Adapter, 2" PP-RCT x 2" NPT	PR4572020	FNPT 2"	73 °F (23 °C) at 270 psi (23 °C)	120 °F (49 °C) at 176 psi (49 °C)	180 °F (82 °C) at 120 psi (82 °C)
Uponor LF Brass Female Threaded Adapter, 1/2" PP-RCT x 1/2" NPT	PR4575050	FNPT 1/2"	73 °F (23 °C) at 270 psi (23 °C)	120 °F (49 °C) at 176 psi (49 °C)	180 °F (82 °C) at 120 psi (82 °C)
Uponor LF Brass Female Threaded Adapter, 1/2" PP-RCT x 3/4" NPT	PR4575075	FNPT 3/4"	73 °F (23 °C) at 270 psi (23 °C)	120 °F (49 °C) at 176 psi (49 °C)	180 °F (82 °C) at 120 psi (82 °C)

3/4" NPT			psi (23 °C)	psi (49 °C)	psi (82 °C)
Uponor LF Brass Female Threaded Adapter, 3/4" PP-RCT x 1/2" NPT	PR4577550	FNPT 1/2"	73 °F (23 °C) at 340 psi (23 °C)	140 °F (49 °C) at 190 psi (49 °C)	180 °F (82 °C) at 100 psi (82 °C)
Uponor LF Brass Female Threaded Adapter, 3/4" PP-RCT x 3/4" NPT	PR4577575	FNPT 3/4"	73 °F (23 °C) at 270 psi (23 °C)	120 °F (49 °C) at 176 psi (49 °C)	180 °F (82 °C) at 120 psi (82 °C)

Installation	Related applications
---------------------	-----------------------------

Use approved socket-fusion connection methods. Refer to the Uponor PP-RCT manual for complete details.

Codes	Standards	Listings
CMC IPC UMC	NSF-61 ASTM E84 NSF-14 ASTM F2389 CSA B137.11	ICC-ES-PMG 1106 APMO-R&T 8358 QAI P321-5 APMO K-12775

Footnotes	Contact information		
-	<table border="0"> <tr> <td>Uponor Inc. 5925 148th Street West Apple Valley, MN 55124 T 800.321.4739 F 952.891.2008</td> <td>Uponor Ltd. 6510 Kennedy Road Mississauga, ON L5T 2X4 T 888.594.7726 F 800.638.9517</td> </tr> </table>	Uponor Inc. 5925 148th Street West Apple Valley, MN 55124 T 800.321.4739 F 952.891.2008	Uponor Ltd. 6510 Kennedy Road Mississauga, ON L5T 2X4 T 888.594.7726 F 800.638.9517
Uponor Inc. 5925 148th Street West Apple Valley, MN 55124 T 800.321.4739 F 952.891.2008	Uponor Ltd. 6510 Kennedy Road Mississauga, ON L5T 2X4 T 888.594.7726 F 800.638.9517		