

ProPEX lead-free (LF) copper stub ells

Project information

| | |
|--------------------------------|-----------------|
| Job name: | Location: |
| Engineer: | Date submitted: |
| Contractor: | Submitted by: |
| Manufacturer's representative: | Approved by: |

Technical data

| | |
|-------------------------|-------------------------------------|
| Material | Copper |
| Subcomponent Material | LF Brass |
| Temp/pressure ratings | Copper |
| | 73 °F (23 °C) at 160 psi (11 bar) |
| | 180 °F (82 °C) at 100 psi (6.9 bar) |
| | 200 °F (93 °C) at 80 psi (5.5 bar) |
| Prop 65 label required? | Yes |

Product information and application use

Uponor ProPEX® lead-free (LF) copper stub ells provide a 90- degree transition from Uponor AquaPEX® tubing to copper. Copper stub ells are comprised of 1/2", 3/4" or 1" type L copper pipe with an Uponor ProPEX fitting on one end and the other end spun closed.

Note: Temperature and pressure ratings stated are hydrostatic ratings. For domestic hot-water (DHW) and DHW recirculation installations, operating conditions should not exceed 140°F (60°C) at 80 psi (5.5 bar) in accordance with ASTM F2023. For additional information regarding application-specific temperature and pressure ratings, refer to the Uponor PEX Piping Systems Design and Installation Manual.

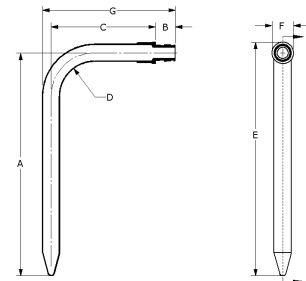

| Part name | Part no. | A [inch] | B [inch] | C [inch] | D [inch] | E [inch] | F [inch] | G [inch] | End Type 1 | Weight per UOM [lbs/UOM] |
|--|-----------|-------------|-------------|-------------|-------------|-------------|-------------|-------------|------------------|--------------------------------|
| ProPEX LF Copper Stub Ell, 1/2" PEX LF Brass x 1/2" Copper (3 1/2" x 8") | LF2865050 | 7.987 | 0.709 | 3.749 | 3.084 | 8.372 | 0.77 | 4.77 | ProPEX 1/2" | 0.2 |
| ProPEX LF Copper Stub Ell, 1/2" PEX LF Brass x 1/2" Copper (13" x 8") | LF2855050 | 7.987 | 0.709 | 12.299 | 3.084 | 8.372 | 0.77 | 13.32 | ProPEX 1/2" | 0.5 |
| ProPEX LF Copper Stub Ell, 1/2" PEX LF Brass x 1/2" Copper (8" x 13") | LF2895050 | 12.985 | 0.709 | 7.295 | 3.04 | 13.37 | 0.77 | 8.316 | ProPEX 1/2" | 0.48 |
| ProPEX LF Copper Stub Ell, 3/4" PEX LF Brass x 3/4" Copper (4" x 8") | LF2897575 | 8.002 | 0.945 | 4.057 | 3.959 | 8.552 | 1.1 | 5.44 | ProPEX 3/4" | 0.5 |
| ProPEX LF Copper Stub Ell, 1" PEX x 1" Copper (13" x 8") | LF2891010 | 13 | 1.181 | 6.507 | 8 | 13.68 | 1.36 | 8.25 | ProPEX 1" | 1.7 |

| Part name | Part no. | Codes | Standards | Listings |
|--|----------|---|---|----------------------|
| ProPEX lead-free (LF) copper stub ells | All | UPC IBC IRC IPC NPC of Canada UMC NSPC IMC | NSF/ANSI/CAN 372 ASTM F877 ASTM F1960 CSA B137.5 NSF/ANSI/CAN 61 NSF/ANSI 14 | IAPMO-ES HUD MR 1269 |

In addition, the following parts have additional codes, standards, or listings:

| | |
|--|-----------|
| ProPEX LF Copper Stub Ell, 1/2" PEX LF Brass x 1/2" Copper (3 1/2" x 8") | LF2865050 |
| ProPEX LF Copper Stub Ell, 1/2" PEX LF Brass x 1/2" Copper (8" x 13") | LF2895050 |
| ProPEX LF Copper Stub Ell, 3/4" PEX LF Brass x 3/4" Copper (4" x 8") | LF2897575 |
| ProPEX LF Copper Stub Ell, 1" PEX x 1" Copper (13" x 8") | LF2891010 |

Installation

Refer to the Uponor AquaPEX Professional Plumbing Installation Guide for additional information

Related applications

PEX-a Plumbing Systems

Footnotes

-

Contact information

Uponor Inc.
5925 148th Street West
Apple Valley, MN 55124
T 800.321.4739
F 952.891.2008

Uponor Ltd.
6510 Kennedy Road
Mississauga, ON L5T 2X4
T 888.594.7726
F 800.638.9517