

TruFLOW Classic assemblies with balancing and isolation valves



Project Information

Job name :	Location :
Engineer :	Date submitted:
Contractor :	Submitted by:
Manufacturer's representative :	Approved by :

Technical data

Material	Brass
Manifold size	1.25 inch
Loop Cv	1.9 Cv
End type 1	ISO 228-G 1-1/4"
End type 2	ISO 228-G 3/4"
Temp/pressure ratings	73 °F (23 °C) at 160 psi (11 bar) 180 °F (82 °C) at 100 psi (6.9 bar) 200 °F (93 °C) at 80 psi (5.5 bar)
Max. fluid flow rate	21 gpm
Prop 65 label required?	Yes

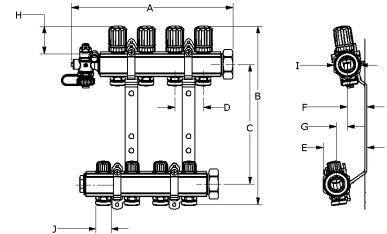

Product information and application use

The Uponor TruFLOW™ Classic Manifold system comes fully assembled. Flow balancing is controlled through manifold adjustments to the balancing valve on the supply manifold. The manifold is mounted on a durable bracket with an end cap on the supply manifold and an end cap with vent and drain on the return manifold. R32 unions on the inlet side of the manifolds allow connections to any manifold adapters offered by Uponor.

Part name	Part no.	A [inch]	B [inch]	C [inch]	D [inch]	E [inch]	F [inch]	G [inch]	H [inch]	I [inch]	J [inch]
TruFLOW Classic Assembly, B&I, 2-loop	A2610200	7.961	12.612	8.248	1.969	3.281	1.523	0.728	1.757	1.811	1.035
TruFLOW Classic Assembly, B&I, 3-loop	A2610300	9.929	12.612	8.248	1.969	3.281	1.523	0.728	1.757	1.811	1.035
TruFLOW Classic Assembly, B&I, 4-loop	A2610400	11.898	12.612	8.248	1.969	3.281	1.523	0.728	1.757	1.811	1.035
TruFLOW Classic Assembly, B&I, 5-loop	A2610500	13.866	12.473	8.248	1.969	3.039	1.365	2.094	1.757	2.31	1.035
TruFLOW Classic Assembly, B&I, 6-loop	A2610600	15.835	12.612	8.248	1.969	3.281	1.523	0.728	1.757	1.811	1.035
TruFLOW Classic Assembly, B&I, 7-loop	A2610700	17.803	12.612	8.248	1.969	3.281	1.523	0.728	1.757	1.811	1.035
TruFLOW Classic Assembly, B&I, 8-loop	A2610800	19.772	12.612	8.248	1.969	3.281	1.523	0.728	1.757	1.811	1.035
TruFLOW Classic Assembly, B&I, 10-loop	A2611000	23.709	12.612	8.248	1.969	3.281	1.523	0.728	1.757	1.811	1.035
TruFLOW Classic Assembly, B&I, 12-loop	A2611200	26.87	12.215	8.249	1.969	2.9	1.285	0.728	1.763	1.811	1.035

Part name	Part no.	Weight per UOM [lbs/UOM]
TruFLOW Classic Assembly, B&I, 2-loop	A2610200	7.94
TruFLOW Classic Assembly, B&I, 3-loop	A2610300	10.57
TruFLOW Classic Assembly, B&I, 4-loop	A2610400	10.71
TruFLOW Classic Assembly, B&I, 5-loop	A2610500	13.7
TruFLOW Classic Assembly, B&I, 6-loop	A2610600	17.23
TruFLOW Classic Assembly, B&I, 7-loop	A2610700	19.19
TruFLOW Classic Assembly, B&I, 8-loop	A2610800	20.81
TruFLOW Classic Assembly, B&I, 10-loop	A2611000	22.85
TruFLOW Classic Assembly, B&I, 12-loop	A2611200	27.81

Installation

TruFLOW Classic manifolds are completely assembled and ready for installation right out of the box. Use the TruFLOW Balancing Hex Key (A2620002) on the internal balancing valves of the supply manifold. Manifold is shipped with the appropriate number of TruFLOW Manifold Actuator Adapters (A2630028). Refer to the TruFLOW Classic Manifold Instruction Sheet for further information.

Related applications

- Radiant Heating and Cooling Systems
- Permafrost Prevention Systems
- Turf Conditioning Systems

Codes

IMC|IRC|NBC of Canada|UMC

Standards

CSA B137.5|R32: ISO 228-G 1 1/4"|ASTM F877|R20: ISO 228-G 3/4"

Listings

cNSFus-rfh

Manifold loop threaded connections:
ISO 228-G 3/4" (R20)

Trademark Information

ProPEX® is a registered trademark of Uponor Inc. ProPEX™ is a trademark of Uponor Ltd.

Contact information

Uponor Inc.
5925 148th Street West
Apple Valley, MN 55124
T 800.321.4739
F 952.891.2008

Uponor Ltd.
6510 Kennedy Road
Mississauga, ON L5T 2X4
T 888.594.7726
F 800.636.9517