

TruFLOW Jr. assemblies with balancing valves and valveless manifolds



Project Information

Job name :	Location :
Engineer :	Date submitted:
Contractor :	Submitted by:
Manufacturer's representative :	Approved by :

Technical data

Material	Brass
Manifold size	1 inch
Loop Cv	1.9 Cv
End type 1	ISO 228-G 1-1/4"
End type 2	ISO 228-G 3/4"
Temp/pressure ratings	73 °F (23 °C) at 160 psi (11 bar) 180 °F (82 °C) at 100 psi (6.9 bar) 200 °F (93 °C) at 80 psi (5.5 bar)
Max. fluid flow rate	14 gpm
Prop 65 label required?	Yes

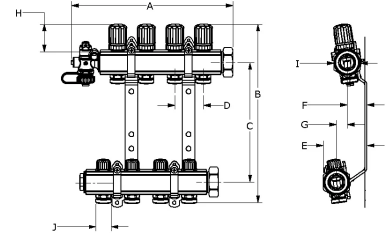

Product information and application use

The TruFLOW™ Jr. Assembly with Balancing Valves and Valveless is fully assembled and ready for installation. Use the TruFLOW Balancing Hex Key on the internal balancing valves of the supply manifold to balance the loops across the manifold. The manifold body ends have R32 unions and the loop outlets have R20 male threads.

Part name	Part no.	A [inch]	B [inch]	C [inch]	D [inch]	E [inch]	F [inch]	G [inch]	I [inch]	J [inch]	Weight per UOM [lbs/UOM]
TruFLOW Jr. Assembly, Balancing Valves and Valveless, 2-loop	A2660200	7.185	11.237	8.248	1.969	2.919	1.285	0.728	1.811	1.035	5.2
TruFLOW Jr. Assembly, Balancing Valves and Valveless, 3-loop	A2660300	9.154	11.237	8.248	1.969	2.919	1.285	0.728	1.811	1.035	5.16
TruFLOW Jr. Assembly, Balancing Valves and Valveless, 4-loop	A2660400	11.122	11.237	8.248	1.969	2.919	1.285	0.728	1.811	1.035	9.6
TruFLOW Jr. Assembly, Balancing Valves and Valveless, 5-loop	A2660500	13.091	11.237	8.248	1.969	2.919	1.285	0.728	1.811	1.035	9.97
TruFLOW Jr. Assembly, Balancing Valves and Valveless, 6-loop	A2660600	15.059	11.237	8.248	1.969	2.919	1.285	0.728	1.811	1.035	12.8
TruFLOW Jr. Assembly, Balancing Valves and Valveless, 7-loop	A2660700	17.028	11.237	8.248	1.969	2.919	1.285	0.728	1.811	1.035	14.1
TruFLOW Jr. Assembly, Balancing Valves and Valveless, 8-loop	A2660800	18.996	11.237	8.248	1.969	2.919	1.285	0.728	1.811	1.035	15.2

Installation

TruFLOW Jr. Manifolds are fully assembled ready for installation. The TruFLOW Balancing Hex Key is used on the internal balancing valves of the supply manifold. Refer to the Uponor TruFLOW Jr. Manifold Instruction Sheet for further information.

Related applications

- Radiant Heating and Cooling Systems
- Permafrost Prevention Systems
- Turf Conditioning Systems

Codes

IMC|IRC|NBC of Canada|UMC

Standards

CSA B137.5|R32: ISO 228-G 1 1/4"|ASTM F877|R20: ISO 228-G 3/4"

Listings

cNSFus-rfh

Notes

Manifold body threaded connections:
R32
Manifold loop threaded connections: R20

Trademark Information

ProPEX® is a registered trademark of Uponor Inc. ProPEX™ is a trademark of Uponor Ltd.

Contact Information

Uponor Inc.
5925 148th Street West
Apple Valley, MN 55124
T 800.321.4739
F 952.891.2008

Uponor Ltd.
6510 Kennedy Road
Mississauga, ON L5T 2X4
T 888.594.7726
F 800.636.9517