

# ProPEX brass ball valves

## Project Information

Job name :	Location :
Engineer :	Date submitted:
Contractor :	Submitted by:
Manufacturer's representative :	Approved by :

## Technical data

Cold working pressure	200.2 psi
Temp/pressure ratings	73 °F (23 °C) at 160 psi (11 bar) 180 °F (82 °C) at 100 psi (6.9 bar) 200 °F (93 °C) at 80 psi (5.5 bar)
Prop 65 label required?	Yes

## Product information and application use

Uponor ProPEX® Brass Ball Valve is a cost-effective alternative for radiant heating/cooling and hydronic piping applications. Both ends are manufactured with the ProPEX fitting for connections to Uponor PEX pipe. The full-port valves are compatible with propylene glycol mixtures up to 50%. Stem extensions can be installed to accommodate up to 2" of pipe insulation. Note: ProPEX Brass Ball Valves are not approved for potable-water applications.

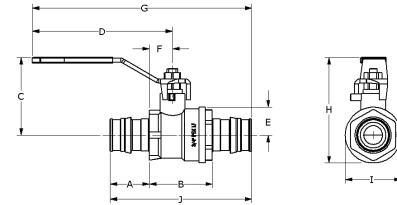

Part name	Part no.	A [inch]	B [inch]	C [inch]	D [inch]	E [inch]	F [inch]	G [inch]	H [inch]	I [inch]	J [inch]
ProPEX Brass Ball Valve 1" PEX x 1" PEX	A3201010	1.181	1.808	2.166	4.47	0.79	0.719	6.74	2.956	1.58	4.17
ProPEX Brass Ball Valve 1 1/4" PEX x 1 1/4" PEX	A3201313	1.445	1.91	2.266	4.47	0.905	0.655	7.17	3.206	1.88	4.8
ProPEX Brass Ball Valve 1 1/2" PEX x 1 1/2" PEX	A3201515	1.704	2.292	2.704	5.57	1.095	0.896	8.67	3.799	2.19	5.7
ProPEX Brass Ball Valve 2" PEX x 2" PEX	A3202020	2.147	2.834	3.374	5.57	1.467	1.103	9.448	4.831	2.915	7.128
ProPEX Brass Ball Valve 1/2" PEX x 1/2" PEX	A3205050	0.709	1.083	1.696	3.37	0.49	0.391	4.77	2.186	0.98	2.5
ProPEX Brass Ball Valve 3/4" PEX x 3/4" PEX	A3207575	0.945	1.51	1.868	3.372	0.63	0.555	5.272	2.498	1.26	3.4
2 3/8" Stem Extension Kit for 1/2" and 3/4" Valves	F5630001	-	-	-	-	-	-	-	-	-	-
2 5/8" Stem Extension Kit for 1" and 1 1/4" Valves	F5630002	-	-	-	-	-	-	-	-	-	-
2 5/8" Stem Extension Kit for 1 1/2" and 2" Valves	F5630003	-	-	-	-	-	-	-	-	-	-

Part name	Part no.	Cv	Weight per UOM [lbs/UOM]	Material group	End Type 1	End Type 2
ProPEX Brass Ball Valve 1" PEX x 1" PEX	A3201010	29	1.3	-	ProPEX 1"	ProPEX 1"
ProPEX Brass Ball Valve 1 1/4" PEX x 1 1/4" PEX	A3201313	54.7	1.44	-	ProPEX 1-1/4"	ProPEX 1-1/4"
ProPEX Brass Ball Valve 1 1/2" PEX x 1 1/2" PEX	A3201515	68.2	2.12	-	ProPEX 1-1/2"	ProPEX 1-1/2"
ProPEX Brass Ball Valve 2" PEX x 2" PEX	A3202020	132.2	4.18	-	ProPEX 2"	ProPEX 2"
ProPEX Brass Ball Valve 1/2" PEX x 1/2" PEX	A3205050	7	0.36	-	ProPEX 1/2"	ProPEX 1/2"
ProPEX Brass Ball Valve 3/4" PEX x 3/4" PEX	A3207575	18	0.52	-	ProPEX 3/4"	ProPEX 3/4"
2 3/8" Stem Extension Kit for 1/2" and 3/4" Valves	F5630001	-	0.31	-	-	-
2 5/8" Stem Extension Kit for 1" and 1 1/4" Valves	F5630002	-	0.48	-	-	-
2 5/8" Stem Extension Kit for 1 1/2" and 2" Valves	F5630003	-	0.57	-	-	-

Installation	Related applications	
<p>Install valve according to local building code. Do not dismantle. Refer to the Uponor Hydronic Piping Design Assistance Manual (HPDAM) or the Uponor Radiant Floor Heating Installation Handbook for additional information.</p>	<p>Hot water distribution  Hydronic heating and cooling systems  Hydronic Piping Systems  Hydronic Radiant Heating and Cooling Systems  PEX-a Plumbing Systems  Plumbing Systems  Pre-Insulated Pipe Systems  Radiant Floor Heating and Cooling Systems  Radiant Heating and Cooling Systems</p>	
Codes	Standards	Listings
IMC UMC	ASTM F1960 CSA B137.5 NSF-14 ASTM F877 NSF-359	cNSFus-rfh
Trademark Information		Contact Information
<p>ProPEX® is a registered trademark of Uponor Inc. ProPEX™ is a trademark of Uponor Ltd.</p>		<p>Uponor Inc.  5925 148th Street West  Apple Valley, MN 55124  T 800.321.4739  F 952.891.2008</p> <p>Uponor Ltd.  6510 Kennedy Road  Mississauga, ON L5T 2X4  T 888.594.7726  F 800.636.9517</p>