

ProPEX brass ball valves

Project information

| | |
|--------------------------------|-----------------|
| Job name: | Location: |
| Engineer: | Date submitted: |
| Contractor: | Submitted by: |
| Manufacturer's representative: | Approved by: |

Technical data

| | |
|-------------------------|-------------------------------------|
| Cv | 132.2 |
| Material | Brass |
| Subcomponent Material | Seal: |
| | PTFE |
| End type 1 | ProPEX 2" |
| End type 2 | ProPEX 2" |
| Cold working pressure | 200.2 psi |
| Temp/pressure ratings | 73 °F (23 °C) at 160 psi (11 bar) |
| | 180 °F (82 °C) at 100 psi (6.9 bar) |
| | 200 °F (93 °C) at 80 psi (5.5 bar) |
| Prop 65 label required? | Yes |

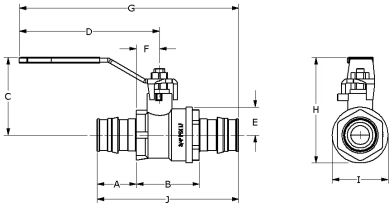

Product information and application use

Uponor ProPEX® Brass Ball Valve is a cost-effective alternative for radiant heating/cooling and hydronic piping applications. Both ends are manufactured with the ProPEX fitting for connections to Uponor PEX pipe. The full-port valves are compatible with propylene glycol mixtures up to 50%. Stem extensions can be installed to accommodate up to 2" of pipe insulation. Note: ProPEX Brass Ball Valves are not approved for potable-water applications.

| Part name | Part no. | A [inch] | B [inch] | C [inch] | D [inch] | E [inch] | F [inch] | G [inch] | H [inch] | I [inch] | J [inch] |
|---|----------|----------|----------|----------|----------|----------|----------|----------|----------|----------|----------|
| ProPEX Brass Ball Valve 2" PEX x 2" PEX | A3202020 | 2.147 | 2.834 | 3.374 | 5.57 | 1.467 | 1.103 | 9.448 | 4.831 | 2.915 | 7.128 |

| Part name | Part no. | Weight per UOM [lbs/UOM] |
|---|----------|--------------------------|
| ProPEX Brass Ball Valve 2" PEX x 2" PEX | A3202020 | 4.18 |

| Part name | Part no. | Codes | Standards | Listings |
|--------------------------|----------|---------|--|------------|
| ProPEX brass ball valves | A3202020 | IMC UMC | ASTM F1960 CSA B137.5 NSF/ANSI 14 ASTM F877 NSF/ANSI 359 | cNSFus-rfh |

| Installation | Related applications |
|--|--|
| Install valve according to local building code. Do not dismantle. Refer to the Uponor Hydronic Piping Design Assistance Manual (HPDAM) or the Uponor Radiant Floor Heating Installation Handbook for additional information. | Hot water distribution |
| | Hydronic heating and cooling systems |
| | Hydronic Piping Systems |
| | Hydronic Radiant Heating and Cooling Systems |
| | PEX-a Plumbing Systems |
| | Plumbing Systems |
| | Pre-Insulated Pipe Systems |
| | Radiant Floor Heating and Cooling Systems |
| | Radiant Heating and Cooling Systems |

| Footnotes | Contact information |
|-----------|---|
| - | <div>Uponor Inc. 5925 148th Street West Apple Valley, MN 55124 T 800.321.4739 F 952.891.2008</div> <div>Uponor Ltd. 6510 Kennedy Road Mississauga, ON L5T 2X4 T 888.594.7726 F 800.638.9517</div> |