

# ProPEX lead-free (LF) brass reducing tees

## Project Information

Job name :	Location :
Engineer :	Date submitted:
Contractor :	Submitted by:
Manufacturer's representative :	Approved by :

## Technical data

Material	LF Brass
Temp/pressure ratings	73 °F (23 °C) at 160 psi (11 bar) 180 °F (82 °C) at 100 psi (6.9 bar) 200 °F (93 °C) at 80 psi (5.5 bar)
Prop 65 label required?	Yes

## Product information and application use

Uponor's ProPEX® LF Brass Reducing Tee makes diverting connections for Uponor PEX tubing in supply and return mains. This product is available for use in hot and cold domestic potable water systems, in any hydronic heating system and in the AquaSAFE™ Residential Fire Safety System. Uponor manufactures each end of the tee with the ProPEX Fitting for easy connections to Wirsbo hePEXTM or Uponor AquaPEX® tubing. This product is safe for direct burial in soil. Note: Branch size is listed last in the part description.

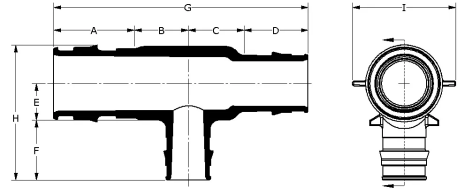

Part name	Part no.	A [Inch]	B [Inch]	C [Inch]	D [Inch]	E [Inch]	F [Inch]	G [Inch]	H [Inch]	I [Inch]	Weight per UOM [lbs/UOM]
ProPEX LF Brass Reducing Tee, 1" PEX x 1" PEX x 1/2" PEX	LF4701150	1.181	0.865	0.865	1.181	0.559	0.709	4.092	1.823	1.46	0.4
ProPEX LF Brass Reducing Tee, 1" PEX x 1" PEX x 3/4" PEX	LF4701175	1.181	0.865	0.865	1.181	0.559	0.945	4.092	2.059	1.46	0.4
ProPEX LF Brass Reducing Tee, 1" PEX x 3/4" PEX x 1" PEX	LF4701751	1.181	0.865	0.865	0.945	0.559	1.181	3.856	2.295	1.46	0.4
ProPEX LF Brass Reducing Tee, 1" PEX x 3/4" PEX x 3/4" PEX	LF4701775	1.181	0.865	0.865	0.945	0.559	0.945	3.856	2.059	1.46	0.3
ProPEX LF Brass Reducing Tee, 3/4" PEX x 3/4" PEX x 1/2" PEX	LF4707550	0.945	0.689	0.689	0.945	0.406	0.709	3.268	1.55	1.2	0.4
ProPEX LF Brass Reducing Tee, 3/4" PEX x 3/4" PEX x 1" PEX	LF4707710	0.945	0.865	0.865	0.945	0.559	1.181	3.62	2.295	1.46	0.5

Part name	Part no.	End Type 1	End Type 2	End Type 3
ProPEX LF Brass Reducing Tee, 1" PEX x 1" PEX x 1/2" PEX	LF4701150	ProPEX 1"	ProPEX 1"	ProPEX 1/2"
ProPEX LF Brass Reducing Tee, 1" PEX x 1" PEX x 3/4" PEX	LF4701175	ProPEX 1"	ProPEX 1"	ProPEX 3/4"
ProPEX LF Brass Reducing Tee, 1" PEX x 3/4" PEX x 1" PEX	LF4701751	ProPEX 1"	ProPEX 3/4"	ProPEX 1"
ProPEX LF Brass Reducing Tee, 1" PEX x 3/4" PEX x 3/4" PEX	LF4701775	ProPEX 1"	ProPEX 3/4"	ProPEX 3/4"
ProPEX LF Brass Reducing Tee, 3/4" PEX x 3/4" PEX x 1/2" PEX	LF4707550	ProPEX 3/4"	ProPEX 3/4"	ProPEX 1/2"
ProPEX LF Brass Reducing Tee, 3/4" PEX x 3/4" PEX x 1" PEX	LF4707710	ProPEX 3/4"	ProPEX 3/4"	ProPEX 1"

## Installation

ProPEX Tool and ProPEX Rings (sold separately) are required for connecting PEX tubing. Refer to the AquaPEX Professional Plumbing Installation Guide, the AquaSAFE Residential Fire Sprinkler Installation Guide or the Radiant Floor Heating Installation Handbook for additional information.

## Related applications

- PEX-a Plumbing Systems
- Uponor Residential Fire Safety Systems
- Radiant Heating and Cooling Systems
- Permafrost Protection Systems
- Turf Conditioning Systems

## Codes

UPC|IBC|IRC|IPC|NPC of Canada|UMC|NSPC|IMC

## Standards

NSF-372|ASTM F877|ASTM F1960|CSA B137.5|JUL 1821|NSF-61|NSF-14

## Listings

cNSFus-pw-fs-G|CC-ES-PMG|APMO 3558|U.P.Code

ProPEX® is a registered trademark of Uponor Inc. ProPEX™ is a trademark of Uponor Ltd.

Uponor Inc.  
5925 148th Street West  
Apple Valley, MN 55124  
T 800.321.4739  
F 952.891.2008

Uponor Ltd.  
6510 Kennedy Road  
Mississauga, ON L5T 2X4  
T 888.594.7726  
F 800.636.9517