

# ProPEX lead-free (LF) brass commercial ball valves

## Project Information

|                                 |                 |
|---------------------------------|-----------------|
| Job name :                      | Location :      |
| Engineer :                      | Date submitted: |
| Contractor :                    | Submitted by:   |
| Manufacturer's representative : | Approved by :   |

## Technical data

|                       |                                      |
|-----------------------|--------------------------------------|
| Cold working pressure | 250 psi                              |
| Temp/pressure ratings | 200 °F (93 °C) at 200 psi (13.8 bar) |

## Product information and application use

To help meet the stringent demands of commercial plumbing and hydronic distribution projects, Uponor is offering new ProPEX® ASTM F1960 lead-free (LF) brass ball valves in sizes from ½" to 2". The full-port ball valves feature a stainless-steel ball and stem for greater durability, longevity, and system performance.

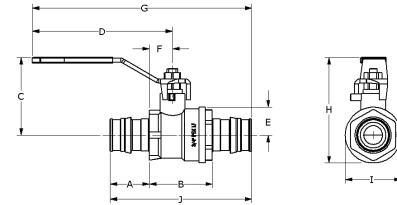

| Part name  | Part no.     | A [inch] | B [inch] | C [inch] | D [inch] | E [inch] | F [inch] | G [inch] | H [inch] | I [inch] | J [inch] |
|--|--------------|----------|----------|----------|----------|----------|----------|----------|----------|----------|----------|
| ProPEX LF Brass Commercial Ball Valve (full port) SS Ball and Stem 1" PEX x 1" PEX         | LFC4821010SS | 1.181    | 1.618    | 2.181    | 4.516    | 0.746    | 0.685    | 6.63     | 2.927    | 1.531    | 3.98     |
| ProPEX LF Brass Commercial Ball Valve (full port) SS Ball and Stem 1 1/4" PEX x 1 1/4" PEX | LFC4821313SS | 1.445    | 1.862    | 2.388    | 4.516    | 0.915    | 0.821    | 7.002    | 3.303    | 1.87     | 4.752    |
| ProPEX LF Brass Commercial Ball Valve (full port) SS Ball and Stem 1 1/2" PEX x 1 1/2" PEX | LFC4821515SS | 1.705    | 2.059    | 3.114    | 5.584    | 1.024    | 0.98     | 8.368    | 4.138    | 2.047    | 5.469    |
| ProPEX LF Brass Commercial Ball Valve (full port) SS Ball and Stem 2" PEX x 2" PEX         | LFC4822020SS | 2.146    | 2.413    | 3.339    | 5.584    | 1.358    | 1.122    | 9.021    | 4.697    | 2.638    | 6.705    |
| ProPEX LF Brass Commercial Ball Valve (full port) SS Ball and Stem 1/2" PEX x 1/2" PEX     | LFC4825050SS | 0.709    | 1.228    | 1.679    | 3.37     | 0.447    | 0.465    | 4.843    | 2.126    | 0.959    | 2.646    |
| ProPEX LF Brass Commercial Ball Valve (full port) SS Ball and Stem 3/4" PEX x 3/4" PEX     | LFC4827575SS | 0.945    | 1.358    | 1.789    | 3.37     | 0.634    | 0.522    | 5.151    | 2.423    | 1.268    | 3.248    |

| Part name  | Part no.     | Cv    | Weight per UOM [lbs/UOM] | End Type 1    | End Type 2    |
|--|--------------|-------|--------------------------|---------------|---------------|
| ProPEX LF Brass Commercial Ball Valve (full port) SS Ball and Stem 1" PEX x 1" PEX         | LFC4821010SS | 29    | 0.89                     | ProPEX 1"     | ProPEX 1"     |
| ProPEX LF Brass Commercial Ball Valve (full port) SS Ball and Stem 1 1/4" PEX x 1 1/4" PEX | LFC4821313SS | 49.1  | 1.36                     | ProPEX 1-1/4" | ProPEX 1-1/4" |
| ProPEX LF Brass Commercial Ball Valve (full port) SS Ball and Stem 1 1/2" PEX x 1 1/2" PEX | LFC4821515SS | 58.9  | 1.99                     | ProPEX 1-1/2" | ProPEX 1-1/2" |
| ProPEX LF Brass Commercial Ball Valve (full port) SS Ball and Stem 2" PEX x 2" PEX         | LFC4822020SS | 139.1 | 3.26                     | ProPEX 2"     | ProPEX 2"     |
| ProPEX LF Brass Commercial Ball Valve (full port) SS Ball and Stem 1/2" PEX x 1/2" PEX     | LFC4825050SS | 6.8   | 0.34                     | ProPEX 1/2"   | ProPEX 1/2"   |
| ProPEX LF Brass Commercial Ball Valve (full port) SS Ball and Stem 3/4" PEX x 3/4" PEX     | LFC4827575SS | 17    | 0.5                      | ProPEX 3/4"   | ProPEX 3/4"   |

| Installation   | Related applications  |   |
|--|---|---|
| <p>Install valve and stem extension kit according to local building code. Do not dismantle. Refer to the Uponor Piping Pocket Guide or the Uponor Plumbing Design Assistance Manual (PDAM) for additional information.</p> | <p>Hot water distribution<br/> Hydronic heating and cooling systems<br/> Hydronic Piping Systems<br/> Hydronic Radiant Heating and Cooling Systems<br/> PEX-a Plumbing Systems<br/> Plumbing Systems<br/> Pre-Insulated Pipe Systems<br/> Radiant Heating and Cooling Systems</p> |   |
| Codes  | Standards   | Listings  |
| UPC IBC IRC IPC NPC of Canada UMC IMC  | NSF-372 ASTM F877 NSF-359 ASTM F1960 CSA B137.5 NSF-61 NSF-14   | cNSFus-pw-G U.P.Code  |
| Trademark information  |   | Contact information   |
| <p>ProPEX® is a registered trademark of Uponor Inc. ProPEX™ is a trademark of Uponor Ltd.</p>  |   | <p>Uponor Inc.<br/> 5925 148th Street West<br/> Apple Valley, MN 55124<br/> T 800.321.4739<br/> F 952.891.2008</p> <p>Uponor Ltd.<br/> 6510 Kennedy Road<br/> Mississauga, ON L5T 2X4<br/> T 888.594.7726<br/> F 800.636.9517</p> |