

# Commercial EP branch multi-port tees

## Project Information

Job name :	Location :
Engineer :	Date submitted:
Contractor :	Submitted by:
Manufacturer's representative :	Approved by :

## Technical data

Material	Engineered Polymer
Temp/pressure ratings	73 °F (23 °C) at 160 psi (11 bar) 180 °F (82 °C) at 100 psi (6.9 bar) 200 °F (93 °C) at 80 psi (5.5 bar)

## Product Information and application use

Commercial engineered polymer (EP) branch multi-port tees feature an integrated 3/4" or 1" ProPEX® inlet with 1/2" ProPEX branch outlets, or a 1 1/4" ProPEX® inlet with 3/4" ProPEX branch outlets. Designed for commercial plumbing applications, they eliminate the need for multiple connections. The 3/4" and 1" multiport tees come with mounting clips featuring Phillips self-tapping screws

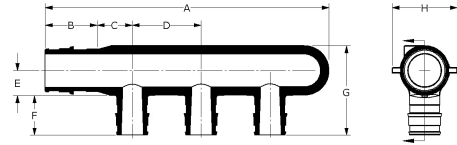

Part name	Part no.	A [Inch]	B [Inch]	C [Inch]	D [Inch]	E [Inch]	F [Inch]	G [Inch]	H [Inch]	Weight per UOM [lbs/UOM]	End Type 1
1" EP Branch Multi-port Tee, 10 (1/2") outlets with mounting clips	Q2101051	11.591	1.191	1.1	0.9	0.65	0.719	2.054	1.768	0.5	ProPEX 1"
1" EP Branch Multi-port Tee, 12 (1/2") outlets with mounting clips	Q2121051	13.391	1.191	1.1	0.9	0.65	0.719	2.054	1.768	0.5	ProPEX 1"
1 1/4" EP Branch Multi-port Tee, 3 (3/4") outlets	Q2231375	6.845	1.445	0.9	1.75	0.7	0.955	2.336	1.82	0.22	ProPEX 1-1/4"
1" EP Branch Multi-port Tee, 7 (1/2") outlets with mounting clips	Q2271051	8.891	1.191	1.1	0.9	0.65	0.719	2.054	1.768	0.33	ProPEX 1"
3/4" EP Branch Multi-port Tee, 7 (1/2") outlets with mounting clips	Q2277550	8.655	0.955	1.1	0.9	0.65	0.719	2.054	1.768	0.33	ProPEX 3/4"
1" EP Branch Multi-port Tee, 8 (1/2") outlets with mounting clips	Q2281051	9.791	1.191	1.1	0.9	0.65	0.719	2.054	1.768	0.45	ProPEX 1"
3/4" EP Branch Multi-port Tee, 8 (1/2") outlets with mounting clips	Q2287550	9.555	0.955	1.1	0.9	0.65	0.719	2.054	1.768	0.44	ProPEX 3/4"

Part name	Part no.	End Type 2	End Type 3
1" EP Branch Multi-port Tee, 10 (1/2") outlets with mounting clips	Q2101051	ProPEX 1/2"	-
1" EP Branch Multi-port Tee, 12 (1/2") outlets with mounting clips	Q2121051	ProPEX 1/2"	-
1 1/4" EP Branch Multi-port Tee, 3 (3/4") outlets	Q2231375	ProPEX 3/4"	ProPEX 3/4"
1" EP Branch Multi-port Tee, 7 (1/2") outlets with mounting clips	Q2271051	ProPEX 1/2"	-
3/4" EP Branch Multi-port Tee, 7 (1/2") outlets with mounting clips	Q2277550	ProPEX 1/2"	-
1" EP Branch Multi-port Tee, 8 (1/2") outlets with mounting clips	Q2281051	ProPEX 1/2"	-
3/4" EP Branch Multi-port Tee, 8 (1/2") outlets with mounting clips	Q2287550	ProPEX 1/2"	ProPEX 1/2"

## Installation

The 3/4" and 1" multi-port tees feature mounting clips with self-tapping screws, which are appropriate for wood or metal studs. Simply attach the clips to the multi-port tee and fasten the clips to the mounting surface. For the 1 1/4" multi-port tee, mount the tee by securing all adjoining PEX pipes to the framing or support structure within 6" of each ProPEX connection. For more information, refer to the Uponor Piping Pocket Guide.

## Related applications

PEX-a Plumbing Systems

Codes	Standards	Listings
UPC IBC IRC IPC NPC of Canada UMC NSPC IMC	ASTM E814 ULC S115 ASTM F877 ASTM F1960 CSA B137.5 ULC S102.2 ASTM E119 UL 263 NSF-61 ULC S101 NSF-14	IAPMO-ESI HUD MR 1269 ICC-ES-PMG cNSFus-pw UL U.P.Code cQAIus P321
Notes		
<p>Maximum multi-port tee flow for 3/4" inlet: 8.8 gpm at 8 fps, 13.2 gpm at 12 fps  Maximum multi-port tee flow for 1" inlet: 14.5 gpm at 8 fps, 21.8 gpm at 12 fps  Maximum multi-port tee flow for 1-1/4"</p> <p>Maximum multi-port tee flow for 3/4" inlet: 8.8 gpm at 8 fps, 13.2 gpm at 12 fps  Maximum multi-port tee flow for 1" inlet: 14.5 gpm at 8 fps, 21.8 gpm at 12 fps  Maximum multi-port tee flow for 1 1/4" inl</p>		
Trademark information	Contact information	
ProPEX® is a registered trademark of Uponor Inc. ProPEX™ is a trademark of Uponor Ltd.	Uponor Inc. 5925 148th Street West Apple Valley, MN 55124 T 800.321.4739 F 952.891.2008	Uponor Ltd. 6510 Kennedy Road Mississauga, ON L5T 2X4 T 888.594.7726 F 800.636.9517