

EP branch multi-port tees

Project information

Job name:	Location:
Engineer:	Date submitted:
Contractor:	Submitted by:
Manufacturer's representative:	Approved by:

Technical data

Material	Engineered Polymer
End type 2	ProPEX 1/2"
Temp/pressure ratings	73 °F (23 °C) at 160 psi (11 bar)
	180 °F (82 °C) at 100 psi (6.9 bar)
	200 °F (93 °C) at 80 psi (5.5 bar)

Product information and application use

Engineered polymer (EP) branch multi-port tees are used in hot and cold domestic potable water distribution systems. The multi-port tees are available with 3/4" or 1" ProPEX® inlets and 1/2" ProPEX outlets.

Note: Temperature and pressure ratings stated are hydrostatic ratings. For domestic hot-water (DHW) and DHW recirculation installations, operating conditions should not exceed 140°F (60°C) at 80 psi (5.5 bar) in accordance with ASTM F2023. For additional information regarding application-specific temperature and pressure ratings, refer to the Uponor PEX Piping Systems Design and Installation Manual.

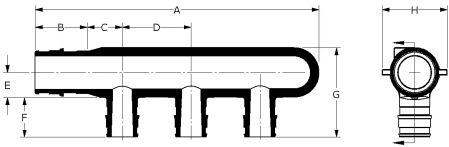

Part name	Part no.	A [inch]	B [inch]	C [inch]	D [inch]	E [inch]	F [inch]	G [inch]	H [inch]	End Type 1	Weight per UOM [lbs/UOM]
3/4" EP Branch Multi-port Tee, 3 (1/2") outlets	Q2237550	4.43	0.955	0.625	1.25	0.48	0.719	1.639	1.22	ProPEX 3/4"	0.1
3/4" EP Branch Multi-port Tee, 4 (1/2") outlets	Q2247550	5.73	0.955	0.625	1.25	0.48	0.719	1.639	1.22	ProPEX 3/4"	0.13
1" EP Branch Multi-port Tee, 4 (1/2") outlets	Q2241050	6.691	1.191	0.775	1.25	0.6	0.719	1.879	1.48	ProPEX 1"	-
3/4" EP Branch Multi-port Tee, 6 (1/2") outlets	Q2267550	8.902	0.955	0.625	1.25	0.457	0.719	1.624	1.18	ProPEX 3/4"	0
1" EP Branch Multi-port Tee, 6 (1/2") outlets	Q2261050	9.251	1.191	0.625	1.25	0.57	0.719	2.009	1.441	ProPEX 1"	0

Part name	Part no.	Codes	Standards	Listings
EP branch multi-port tees	All	UPC IBC IRC IPC NPC of Canada UMC NSPC IMC	ASTM E814 ULC S115 ASTM F877 ASTM F1960 CSA B137.5 ULC S102.2 ASTM E119 UL 263 NSF-61 ULC S101 NSF-14	IAPMO-ES HUD MR 1269 ICC-ES-PMG cNSFus-pw UL U.P.Code cQAlus P321

Installation	Related applications
For a mounting bracket, use any product designed to mount 1" copper pipe for the 3/4" multi-port tee or 1 1/4" copper pipe for the 1" multi-port tee. For more information, refer to the Uponor Piping Systems Installation Guide.	PEX-a Plumbing Systems

Footnotes	Contact information
-	Uponor Inc. 5925 148th Street West Apple Valley, MN 55124 T 800.321.4739 F 952.891.2008  Uponor Ltd. 6510 Kennedy Road Mississauga, ON L5T 2X4 T 888.594.7726 F 800.638.9517