

ProPEX lead-free (LF) brass residential ball valves

Project Information

| | |
|---------------------------------|-----------------|
| Job name : | Location : |
| Engineer : | Date submitted: |
| Contractor : | Submitted by: |
| Manufacturer's representative : | Approved by : |

Technical data

| | |
|-------------------------|--------------------------------------|
| Material | LF Brass |
| Manifold size | inch |
| Temp/pressure ratings | 200 °F (93 °C) at 200 psi (13.8 bar) |
| Prop 65 label required? | Yes |

Product information and application use

To help meet the stringent demands of residential plumbing and hydronic distribution projects, Uponor is offering new ProPEX® ASTM F1960 lead-free (LF) brass ball valves in sizes from ½" to 1". The full-port ball valves feature a chrome-plated ball.

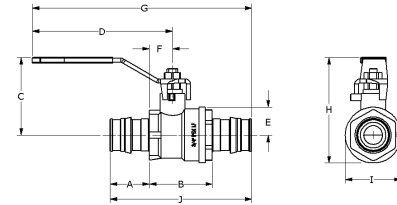

| Part name | Part no. | A [inch] | B [inch] | C [inch] | D [inch] | E [inch] | F [inch] | G [inch] | H [inch] | I [inch] | J [inch] |
|--|------------|----------|----------|----------|----------|----------|----------|----------|----------|----------|----------|
| ProPEX LF Brass Stop and Drain Ball Valve (full port), 1" PEX x 1" PEX | LFD4811010 | 1.181 | 1.862 | 1.978 | 4.227 | 0.746 | 0.909 | 6.361 | 2.724 | 2.022 | 4.224 |
| ProPEX LF Brass Stop and Drain Ball Valve (full port), 1/2" PEX x 1/2" PEX | LFD4815050 | 0.709 | 1.449 | 2.867 | 3.681 | 1.624 | 0.725 | 5.114 | 2.071 | 1.437 | 2.867 |
| ProPEX LF Brass Stop and Drain Ball Valve (full port), 3/4" PEX x 3/4" PEX | LFD4817575 | 0.945 | 1.657 | 1.841 | 4.241 | 0.602 | 0.803 | 6.04 | 2.443 | 1.726 | 3.548 |
| ProPEX LF Brass Ball Valve (full port), 1" PEX x 1" PEX | LFR4811010 | 1.181 | 1.618 | 2.208 | 4.503 | 0.746 | 0.685 | 6.617 | 2.954 | 1.492 | 3.98 |
| ProPEX LF Brass Ball Valve (full port), 1/2" PEX x 1/2" PEX | LFR4815050 | 0.709 | 1.228 | 1.647 | 3.361 | 0.447 | 0.465 | 4.834 | 2.094 | 0.939 | 2.646 |
| ProPEX LF Brass Ball Valve (full port), 3/4" PEX x 3/4" PEX | LFR4817575 | 0.945 | 1.357 | 1.796 | 3.361 | 0.634 | 0.522 | 5.142 | 2.43 | 1.268 | 3.247 |

| Part name | Part no. | Cv | Cv Through | Weight per UOM [lbs/UOM] | End Type 1 | End Type 2 |
|--|------------|------|------------|--------------------------|-------------|-------------|
| ProPEX LF Brass Stop and Drain Ball Valve (full port), 1" PEX x 1" PEX | LFD4811010 | 31.7 | - | 0.9 | ProPEX 1" | ProPEX 1" |
| ProPEX LF Brass Stop and Drain Ball Valve (full port), 1/2" PEX x 1/2" PEX | LFD4815050 | 6.5 | - | 0.35 | ProPEX 1/2" | ProPEX 1/2" |
| ProPEX LF Brass Stop and Drain Ball Valve (full port), 3/4" PEX x 3/4" PEX | LFD4817575 | 16.6 | - | 0.6 | ProPEX 3/4" | ProPEX 3/4" |
| ProPEX LF Brass Ball Valve (full port), 1" PEX x 1" PEX | LFR4811010 | 31.4 | - | 0.88 | ProPEX 1" | ProPEX 1" |
| ProPEX LF Brass Ball Valve (full port), 1/2" PEX x 1/2" PEX | LFR4815050 | 6.7 | - | 0.34 | ProPEX 1/2" | ProPEX 1/2" |
| ProPEX LF Brass Ball Valve (full port), 3/4" PEX x 3/4" PEX | LFR4817575 | 15.8 | - | 0.5 | ProPEX 3/4" | ProPEX 3/4" |

Installation

Install valve and stem extension kit according to local building code. Do not dismantle. Refer to the Uponor Piping Pocket Guide or the Uponor Plumbing Design Assistance Manual (PDAM) for additional information.

Related applications

- Hot water distribution
- Hydronic heating and cooling systems
- Hydronic Piping Systems
- Hydronic Radiant Heating and Cooling Systems
- PEX-a Plumbing Systems
- Plumbing Systems
- Pre-Insulated Pipe Systems
- Radiant Heating and Cooling Systems

| Codes | Standards | Listings |
|---------------------------------------|---|----------------------|
| UPC IBC IRC IPC NPC of Canada UMC IMC | NSF-372 ASTM F877 NSF-359 ASTM F1960 CSA B137.5 NSF-61 NSF-14 | cNSFus-pw-G U.P.Code |

| Trademark information | Contact information | | |
|---|--|---|---|
| ProPEX® is a registered trademark of Uponor Inc. ProPEX™ is a trademark of Uponor Ltd. | <table border="0"> <tr> <td>Uponor Inc. 5925 148th Street West Apple Valley, MN 55124 T 800.321.4739 F 952.891.2008</td> <td>Uponor Ltd. 6510 Kennedy Road Mississauga, ON L5T 2X4 T 888.594.7726 F 800.636.9517</td> </tr> </table> | Uponor Inc. 5925 148th Street West Apple Valley, MN 55124 T 800.321.4739 F 952.891.2008 | Uponor Ltd. 6510 Kennedy Road Mississauga, ON L5T 2X4 T 888.594.7726 F 800.636.9517 |
| Uponor Inc. 5925 148th Street West Apple Valley, MN 55124 T 800.321.4739 F 952.891.2008 | Uponor Ltd. 6510 Kennedy Road Mississauga, ON L5T 2X4 T 888.594.7726 F 800.636.9517 | | |