

Soportes de curvatura de metal

Project information

Job name:	Location:
Engineer:	Fecha de envío:
Contractor:	Presentada por:
Manufacturer's representative:	Approved by:

Technical data

Material Metal

Product information and application use

Snap the tubing into the Metal Bend Support at the beginning of the bend. Continue the bend through the support and snap the tubing into the support at the end of the bend. Refer to the Uponor AquaPEX® Professional Plumbing Installation Guide or the Uponor Radiant Floor Heating Installation Handbook for additional information.

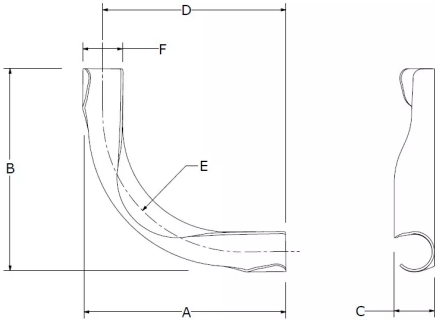

Part name	Part no.	Subcomponent Material
3/8" Metal Bend Support	A5110375	SPHC steel
1/2" Metal Bend Support	A5110500	-
5/8" Metal Bend Support	A5110625	-
3/4" Metal Bend Support	A5110750	-

Installation	Related applications
Snap the pipe into the metal bend support at the beginning of the bend. Continue the bend through the support, and snap the pipe into the support at the end of the bend. Refer to the Uponor Piping Systems Installation Guide or the Uponor Radiant Floor Heating Installation Handbook for additional information.	PEX-a Plumbing Systems Radiant Heating and Cooling Systems AquaSAFE™ Fire Safety Systems Hydronic Piping Systems

Footnotes	Contact information
-	Uponor Inc. 5925 148th Street West Apple Valley, MN 55124 T 800.321.4739 F 952.891.2008 Uponor Ltd. 6510 Kennedy Road Mississauga, ON L5T 2X4 T 888.594.7726 F 800.638.9517