

Soportes de curvatura de plástico de 90 grados

Project information

Job name:	Location:
Engineer:	Fecha de envío:
Contractor:	Presentada por:
Manufacturer's representative:	Approved by:

Technical data

Material Plastic

Product information and application use

Plastic Bend Support (glass-reinforced nylon) provides rigid 90-degree bend and sleeve for $\frac{3}{8}$ ", $\frac{1}{2}$ " and $\frac{3}{4}$ " Uponor PEX tubing.

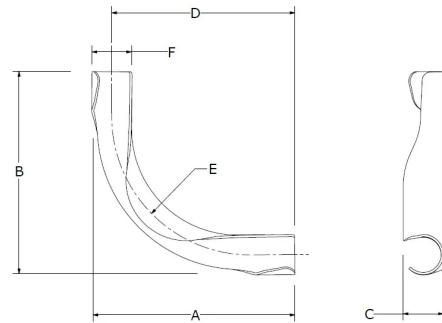

Part name	Part no.	A [inch]	B [inch]	C [inch]	D [inch]	E [inch]	F [inch]	Subcomponent Material	Weight per UOM [lbs/UOM]
3/8" Plastic Bend Support	A5150375	3.866	4.071	1.025	3.448	2.475	1.025	Glass-reinforced nylon	0.05
1/2" Plastic Bend Support	A5250500	3.644	3.646	0.927	3.125	2.385	1.04	Glass-reinforced nylon	0.05
3/4" Plastic Bend Support	A5150750	6.109	6.11	1.225	5.517	3.84	1.185	Glass-reinforced nylon	0.15
1/2" Plastic Bend Support (not for use with Wall Support Bracket A5750500)	A5150500	4.062	4.062	0.99	3.5	2.341	0.99	-	0.05

Installation

Snap the tubing into the Bend Support at the beginning of the bend. Continue the bend through the support and snap the tubing into the support at the end of the bend as well. Refer to the Uponor PEX Piping Systems Design and Installation Manual for additional information.

Related applications

PEX-a Plumbing Systems
AquaSAFE™ Fire Safety Systems
Hydronic Distribution Systems
Radiant Heating and Cooling Systems

Footnotes

-

Contact information

Uponor Inc.
5925 148th Street West
Apple Valley, MN 55124
T 800.321.4739
F 952.891.2008

Uponor Ltd.
6510 Kennedy Road
Mississauga, ON L5T 2X4
T 888.594.7726
F 800.638.9517