

Conectores multipuerto en T en ramal de EP

Project information	
Job name:	Location:
Engineer:	Fecha de envío:
Contractor:	Presentada por:
Manufacturer's representative:	Approved by:

Technical data	
Material	Engineered Polymer
End type 2	ProPEX 1/2"
Temp/pressure ratings	73 °F (23 °C) at 160 psi (11 bar)
	180 °F (82 °C) at 100 psi (6.9 bar)
	200 °F (93 °C) at 80 psi (5.5 bar)

Product information and application use

Engineered polymer (EP) branch multi-port tees are used in hot and cold domestic potable water distribution systems. The multi-port tees are available with 3/4" or 1" ProPEX® inlets and 1/2" ProPEX outlets.

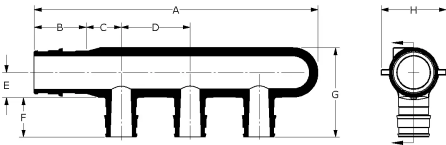

Note: Temperature and pressure ratings stated are hydrostatic ratings. For domestic hot-water (DHW) and DHW recirculation installations, operating conditions should not exceed 140°F (60°C) at 80 psi (5.5 bar) in accordance with ASTM F2023. For additional information regarding application-specific temperature and pressure ratings, refer to the Uponor PEX Piping Systems Design and Installation Manual.

Part name	Part no.	A [inch]	B [inch]	C [inch]	D [inch]	E [inch]	F [inch]	G [inch]	H [inch]	End Type 1	Prop 65 label required?
3/4" EP Branch Multi-port Tee, 3 (1/2") outlets	Q2237550	4.43	0.955	0.625	1.25	0.48	0.719	1.639	1.22	ProPEX 3/4"	-
3/4" EP Branch Multi-port Tee, 4 (1/2") outlets	Q2247550	5.73	0.955	0.625	1.25	0.48	0.719	1.639	1.22	ProPEX 3/4"	-
1" EP Branch Multi-port Tee, 4 (1/2") outlets	Q2241050	6.691	1.191	0.775	1.25	0.6	0.719	1.879	1.48	ProPEX 1"	-
3/4" EP Branch Multi-port Tee, 6 (1/2") outlets	Q2267550	8.23	0.955	0.625	1.25	0.48	0.719	1.639	1.22	ProPEX 3/4"	No
1" EP Branch Multi-port Tee, 6 (1/2") outlets	Q2261050	9.251	1.191	0.625	1.25	0.57	0.719	2.009	1.441	ProPEX 1"	-

Part name	Part no.	Weight per UOM [lbs/UOM]
3/4" EP Branch Multi-port Tee, 3 (1/2") outlets	Q2237550	0.1
3/4" EP Branch Multi-port Tee, 4 (1/2") outlets	Q2247550	0.13
1" EP Branch Multi-port Tee, 4 (1/2") outlets	Q2241050	-
3/4" EP Branch Multi-port Tee, 6 (1/2") outlets	Q2267550	0.18
1" EP Branch Multi-port Tee, 6 (1/2") outlets	Q2261050	0

Part name	Part no.	Codes	Standards	Listings
Conectores multipuerto en T en ramal de EP	All	UPC IBC IRC IPC NPC of Canada UMC NSPC IMC	ASTM E814 ULC S115 ASTM F877 ASTM F1960 CSA B137.5 ULC S102.2 ASTM E119 UL 263 ULC S101	IAPMO-ES HUD MR 1269 ICC-ES-PMG cNSFus-pw UL U.P.Code cQAlus P321
In addition, the following parts have additional codes, standards, or listings:				
3/4" EP Branch Multi-port Tee, 3 (1/2") outlets	Q2237550		NSF/ANSI/CAN 61 NSF/ANSI 14	
3/4" EP Branch Multi-port Tee, 4 (1/2") outlets	Q2247550		NSF-61 NSF-14	
1" EP Branch Multi-port Tee, 4 (1/2") outlets	Q2241050		NSF/ANSI/CAN 61 NSF/ANSI 14	
3/4" EP Branch Multi-port Tee, 6 (1/2") outlets	Q2267550		NSF/ANSI/CAN 61 NSF/ANSI 14	
1" EP Branch Multi-port Tee, 6 (1/2") outlets	Q2261050		NSF/ANSI/CAN 61 NSF/ANSI 14	

Installation	Related applications
For a mounting bracket, use any product designed to mount 1" copper pipe for the ¾" multi-port tee or 1¼" copper pipe for the 1" multi-port tee. For more information, refer to the Uponor Piping Systems Installation Guide.	PEX-a Plumbing Systems

Footnotes	Contact information
-	<div>Uponor Inc. 5925 148th Street West Apple Valley, MN 55124 T 800.321.4739 F 952.891.2008</div> <div>Uponor Ltd. 6510 Kennedy Road Mississauga, ON L5T 2X4 T 888.594.7726 F 800.638.9517</div>