

Conectores en T de EP ProPEX

Project Information

Job name:	Location:
Engineer:	Fecha de envío:
Contractor:	Presentada por:
Manufacturer's representative:	Approved by:

Technical data

Material	Engineered Polymer
Temp/pressure ratings	73 °F (23 °C) at 160 psi (11 bar)
	180 °F (82 °C) at 100 psi (6.9 bar)
	200 °F (93 °C) at 80 psi (5.5 bar)

Product Information and application use

ProPEX® engineered polymer (EP) tees make diverting connections for Uponor crosslinked polyethylene (PEX-a) tubing for use in hot and cold domestic potable water systems, residential fire sprinkler systems and hydronic radiant heating and cooling systems. Each end of the tee is manufactured with an Uponor ProPEX fitting for connections to Uponor AquaPEX® or Wirsbo hePEX™ tubing. Note: Branch size is listed last in the part descriptions.

Note: Temperature and pressure ratings stated are hydrostatic ratings. For domestic hot-water (DHW) and DHW recirculation installations, operating conditions should not exceed 140°F (60°C) at 80 psi (5.5 bar) in accordance with ASTM F2023. For additional information regarding application-specific temperature and pressure ratings, refer to the Uponor PEX Piping Systems Design and Installation Manual.

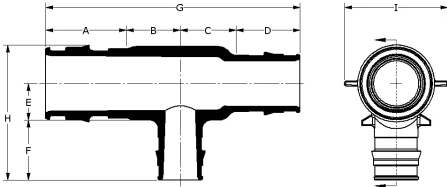

Part name	Part no.	Cv Through	Cv Branch	End Type 1	End Type 2	End Type 3	Prop 65 label required?
ProPEX EP Tee, 1/2" PEX x 1/2" PEX x 1/2" PEX	Q4755050	7.7	3.4	ProPEX 1/2"	ProPEX 1/2"	ProPEX 1/2"	-
ProPEX EP Tee, 3/4" PEX x 3/4" PEX x 3/4" PEX	Q4757575	15.7	5.4	ProPEX 3/4"	ProPEX 3/4"	ProPEX 3/4"	-
ProPEX EP Tee, 1" PEX x 1" PEX x 1" PEX	Q4751010	30.5	11.3	ProPEX 1"	ProPEX 1"	ProPEX 1"	-
ProPEX EP Tee, 1 1/4" PEX x 1 1/4" PEX x 1 1/4" PEX	Q4751313	34	23.9	ProPEX 1-1/4"	ProPEX 1-1/4"	ProPEX 1-1/4"	No
ProPEX EP Tee, 1 1/2" PEX x 1 1/2" PEX x 1 1/2" PEX	Q4751515	63.7	31	ProPEX 1-1/2"	ProPEX 1-1/2"	ProPEX 1-1/2"	No
ProPEX EP Tee, 2" PEX x 2" PEX x 2" PEX	Q4752000	150.7	52.5	ProPEX 2"	ProPEX 2"	ProPEX 2"	-
ProPEX EP Tee, 2 1/2" PEX x 2 1/2" PEX x 2 1/2" PEX	Q4752500	197.2	81.5	ProPEX 2-1/2"	ProPEX 2-1/2"	ProPEX 2-1/2"	-
ProPEX EP Tee, 3" PEX x 3" PEX x 3" PEX	Q4753000	286.6	122.8	ProPEX 3"	ProPEX 3"	ProPEX 3"	-

Part name	Part no.	Codes	Standards	Listings
Conectores en T de EP ProPEX	All	IMC UPC IBC IRC IPC NPC of Canada UMC NSPC	ASTM F1960 ASTM E119/UL 263 ASTM E84 ASTM E814/ULC S115 ASTM F877 CSA B137.5 ULC S102.2 ULC S101	IAPMO-ES ICC-ES-PMG UL U.P.Code cQAlus P321 HUD MR 1269
In addition, the following parts have additional codes, standards, or listings:				
ProPEX EP Tee, 1/2" PEX x 1/2" PEX x 1/2" PEX	Q4755050		NSF-61 NSF-14	cNSFus-pw
ProPEX EP Tee, 3/4" PEX x 3/4" PEX x 3/4" PEX	Q4757575		UL 1821 NSF-61 NSF-14	cNSFus-pw-fs
ProPEX EP Tee, 1" PEX x 1" PEX x 1" PEX	Q4751010		UL 1821 NSF-61 NSF-14	cNSFus-pw-fs
ProPEX EP Tee, 1 1/4" PEX x 1 1/4" PEX x 1 1/4" PEX	Q4751313		UL 1821 NSF/ANSI/CAN 61 NSF/ANSI 14	cNSFus-pw-fs
ProPEX EP Tee, 1 1/2" PEX x 1 1/2" PEX x 1 1/2" PEX	Q4751515		NSF-61 NSF-14	cNSFus-pw
ProPEX EP Tee, 2" PEX x 2" PEX x 2" PEX	Q4752000		NSF-61 NSF-14	cNSFus-pw
ProPEX EP Tee, 2 1/2" PEX x 2 1/2" PEX x 2 1/2" PEX	Q4752500		ASTM E814 NSF-61 NSF-14	cNSFus-pw
ProPEX EP Tee, 3" PEX x 3" PEX x 3" PEX	Q4753000		NSF-61 NSF-14	cNSFus-pw

Installation		Related applications	
Use the appropriate ProPEX Ring for PEX-a tubing. Refer to the Uponor Professional Plumbing Installation Guide, AquaSAFE™ Residential Fire Sprinkler Installation Guide or Uponor Radiant Installation Handbook for additional information		PEX-a Plumbing Systems	
		Hydronic Radiant Heating and Cooling Systems	
		Turf Conditioning Systems	
		Permafrost Prevention Systems	
Footnotes		Contact information	
-		Uponor Inc.	
		5925 148th Street West	
		Apple Valley, MN 55124	
		T 800.321.4739	
		F 952.891.2008	
		Uponor Ltd.	
		6510 Kennedy Road	
		Mississauga, ON L5T 2X4	
		T 888.594.7726	
		F 800.638.9517	