

Soportes de curvatura de plástico de 45 grados

Project information

Job name:	Location:
Engineer:	Fecha de envío:
Contractor:	Presentada por:
Manufacturer's representative:	Approved by:

Technical data

Material	Plastic
Subcomponent Material	Glass-reinforced nylon

Product information and application use

Plastic Bend Support (glass-reinforced nylon) provides rigid 45-degree bend and sleeve for 1/2" and 3/4" Uponor PEX tubing.

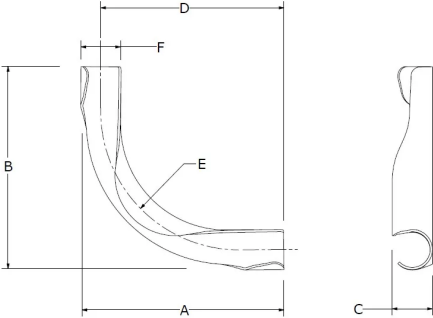

Part name	Part no.	A [inch]	B [inch]	C [inch]	D [inch]	E [inch]	F [inch]	Weight per UOM [lbs/UOM]
1/2" 45-degree Plastic Bend Support	A5250545	5.798	3.135	0.99	5.478	4.724	1.062	0.07
3/4" 45-degree Plastic Bend Support	A5150745	5.872	3.259	1.187	5.478	4.724	1.191	0.09

Installation

Snap the tubing into the bend support at the beginning of the bend. Continue the bend through the support and snap the tubing into the support at the end of the bend as well. Refer to the Uponor PEX Piping Systems Design and Installation Manual for additional information.

Related applications

- PEX-a Plumbing Systems
- AquaSAFE™ Fire Safety Systems
- Hydronic Distribution Systems
- Radiant Heating and Cooling Systems

Footnotes

-

Contact information

Uponor Inc.
5925 148th Street West
Apple Valley, MN 55124
T 800.321.4739
F 952.891.2008

Uponor Ltd.
6510 Kennedy Road
Mississauga, ON L5T 2X4
T 888.594.7726
F 800.638.9517