

# Supports de cintrage en plastique

## Renseignements sur le projet

Nom du poste :

Lieu :

Ingénieur :

Date de soumission:

Entrepreneur :

Présentée par:

Représentant du fabricant :

Approuvé par :

## Données techniques

Material Plastic

## Informations sur le produit et utilisation de l'application

Plastic Bend Support (glass-reinforced nylon) provides rigid 90-degree bend and sleeve for  $\frac{3}{8}$ " ,  $\frac{1}{2}$ " and  $\frac{3}{4}$ " Uponor PEX tubing.

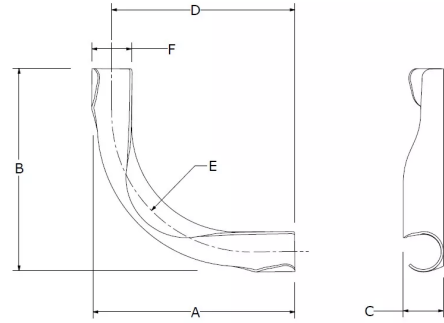

Nom de la pièce	Numéro de pièce	A [Inch]	B [Inch]	C [Inch]	D [Inch]	E [Inch]	F [Inch]	Weight per UOM [lbs/UOM]
3/8" Plastic Bend Support	A5150375	3.866	4.071	1.025	3.448	2.475	1.025	0.05
3/4" Plastic Bend Support	A5150750	6.109	6.11	1.225	5.517	3.84	1.185	0.15
1/2" Plastic Bend Support	A5250500	3.644	3.646	0.52	3.125	2.385	0.52	0.05
1/2" Plastic Bend Support (not for use with Wall Support Bracket A5750500)	A5150500	4.062	4.062	0.99	3.5	2.341	0.99	0.05

## L'installation

Snap the tubing into the Bend Support at the beginning of the bend. Continue the bend through the support and snap the tubing into the support at the end of the bend as well. Refer to the AQUAPEX® Professional Plumbing Installation Handbook or Uponor Radiant Installation Handbook for additional information.

## Applications connexes

- PEX-a Plumbing Systems
- Fire Safety Systems
- Hydronic Distribution Systems
- Radiant Heating and Cooling Systems

## Les codes

## Normes

## Annonces

-

-

-

## Notes de bas de page

## Coordonnées de la personne-ressource

-

Uponor Inc.  
5925 148th Street West  
Apple Valley, MN 55124  
T 800.321.4739  
F 952.891.2008

Uponor Ltd.  
6510 Kennedy Road  
Mississauga, ON L5T 2X4  
T 888.594.7726  
F 800.638.9517