

# Tés réducteurs ProPEX en EP - jusqu'à 1,5 po

## Renseignements sur le projet

|                             |                     |
|-----------------------------|---------------------|
| Nom du poste :              | Lieu :              |
| Ingénieur :                 | Date de soumission: |
| Entrepreneur :              | Présentée par:      |
| Représentant du fabricant : | Approuvé par :      |

## Données techniques

|                       |                                     |
|-----------------------|-------------------------------------|
| Temp/pressure ratings | 73 °F (23 °C) at 160 psi (11 bar)   |
|                       | 180 °F (82 °C) at 100 psi (6.9 bar) |
|                       | 200 °F (93 °C) at 80 psi (5.5 bar)  |

## Informations sur le produit et utilisation de l'application

ProPEX® engineered polymer (EP) reducing tees make diverting connections for Uponor crosslinked polyethylene (PEX-a) tubing for use in hot and cold domestic potable water systems, residential fire sprinkler systems and hydronic radiant heating and cooling systems. Each end of the tee is manufactured with an Uponor ProPEX fitting for connections to Uponor AquaPEX® or Wirsbo hePEX™ tubing. 1 Note: Branch size is listed last in the part descriptions.

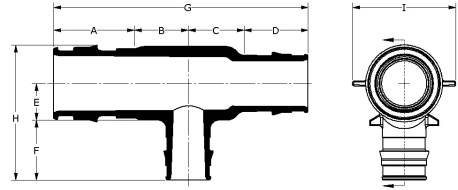

Related: [ProPEX EP reducing tees - 2in and up](#)

Note: Temperature and pressure ratings stated are hydrostatic ratings. For domestic hot-water (DHW) and DHW recirculation installations, operating conditions should not exceed 140°F (60°C) at 80 psi (5.5 bar) in accordance with ASTM F2023. For additional information regarding application-specific temperature and pressure ratings, refer to the Uponor PEX Piping Systems Design and Installation Manual.

| Nom de la pièce  | Número de pièce | Cv Through | Material group     | Cv Branch | End Type 1    | End Type 2    | End Type 3    | Prop 65 label required? | Cv  |
|--|-----------------|------------|--------------------|-----------|---------------|---------------|---------------|-------------------------|-----|
| ProPEX EP Reducing Tee, 1/2" PEX x 1/2" PEX x 3/4" PEX     | Q4755575        | 7.7        | Engineered Polymer | 5.4       | ProPEX 1/2"   | ProPEX 1/2"   | ProPEX 3/4"   | -                       | -   |
| ProPEX EP Reducing Tee, 3/4" PEX x 1/2" PEX x 1/2" PEX     | Q4757555        | 4.6        | Engineered Polymer | 3.4       | ProPEX 3/4"   | ProPEX 1/2"   | ProPEX 1/2"   | -                       | -   |
| ProPEX EP Reducing Tee, 3/4" PEX x 3/4" PEX x 1/2" PEX     | Q4757550        | 14.2       | Engineered Polymer | 3.1       | ProPEX 3/4"   | ProPEX 3/4"   | ProPEX 1/2"   | -                       | -   |
| ProPEX EP Reducing Tee, 3/4" PEX x 3/4" PEX x 5/8" PEX     | Q4757563        | 15.7       | Engineered Polymer | 5.4       | ProPEX 3/4"   | ProPEX 3/4"   | ProPEX 5/8"   | -                       | -   |
| ProPEX EP Reducing Tee, 3/4" PEX x 3/4" PEX x 1" PEX       | Q4757710        | 15.7       | Engineered Polymer | 8.7       | ProPEX 3/4"   | ProPEX 3/4"   | ProPEX 1"     | -                       | 2.6 |
| ProPEX EP Reducing Tee, 1" PEX x 3/4" PEX x 3/4" PEX       | Q4751775        | 12.8       | Engineered Polymer | 5.3       | ProPEX 1"     | ProPEX 3/4"   | ProPEX 3/4"   | -                       | -   |
| ProPEX EP Reducing Tee, 1" PEX x 3/4" PEX x 1" PEX         | Q4751751        | 12.9       | Engineered Polymer | 10.5      | ProPEX 1"     | ProPEX 3/4"   | ProPEX 1"     | -                       | -   |
| ProPEX EP Reducing Tee, 1" PEX x 1" PEX x 1/2" PEX         | Q4751150        | 32.2       | Engineered Polymer | 3.4       | ProPEX 1"     | ProPEX 1"     | ProPEX 1/2"   | -                       | -   |
| ProPEX EP Reducing Tee, 1" PEX x 1" PEX x 3/4" PEX         | Q4751175        | 27.8       | Engineered Polymer | 8.2       | ProPEX 1"     | ProPEX 1"     | ProPEX 3/4"   | -                       | -   |
| ProPEX EP Reducing Tee, 1 1/4" PEX x 1" PEX x 3/4" PEX     | Q4751317        | 21         | Engineered Polymer | 9.3       | ProPEX 1-1/4" | ProPEX 1"     | ProPEX 3/4"   | -                       | -   |
| ProPEX EP Reducing Tee, 1 1/4" PEX x 1" PEX x 1" PEX       | Q4751311        | 11.7       | Engineered Polymer | 8.4       | ProPEX 1-1/4" | ProPEX 1"     | ProPEX 1"     | -                       | -   |
| ProPEX EP Reducing Tee, 1 1/4" PEX x 1 1/4" PEX x 1/2" PEX | Q4751350        | 45.2       | Engineered Polymer | 4.1       | ProPEX 1-1/4" | ProPEX 1-1/4" | ProPEX 1/2"   | -                       | -   |
| ProPEX EP Reducing Tee, 1 1/4" PEX x 1 1/4" PEX x 3/4" PEX | Q4751337        | 43.4       | Engineered Polymer | 8.9       | ProPEX 1-1/4" | ProPEX 1-1/4" | ProPEX 3/4"   | -                       | -   |
| ProPEX EP Reducing Tee, 1 1/4" PEX x 1 1/4" PEX x 1" PEX   | Q4751331        | 33         | Engineered Polymer | 15.8      | ProPEX 1-1/4" | ProPEX 1-1/4" | ProPEX 1"     | No                      | -   |
| ProPEX EP Reducing Tee, 1 1/2" PEX x 1" PEX x 3/4" PEX     | Q4751517        | 19.5       | Engineered Polymer | 9.3       | ProPEX 1-1/2" | ProPEX 1"     | ProPEX 3/4"   | -                       | -   |
| ProPEX EP Reducing Tee, 1 1/2" PEX x 1" PEX x 1" PEX       | Q4751511        | 18.9       | Engineered Polymer | 15.6      | ProPEX 1-1/2" | ProPEX 1"     | ProPEX 1"     | -                       | -   |
| ProPEX EP Reducing Tee, 1 1/2" PEX x 1" PEX x 1 1/2" PEX   | Q4751505        | 19         | Engineered Polymer | 26.5      | ProPEX 1-1/2" | ProPEX 1"     | ProPEX 1-1/2" | -                       | -   |

|  |          |      |                    |      |               |               |               |    |   |
|--|----------|------|--------------------|------|---------------|---------------|---------------|----|---|
| ProPEX EP Reducing Tee, 1 1/2" PEX x 1 1/4" PEX x 3/4" PEX   | Q4751537 | 33.1 | Engineered Polymer | 6.3  | ProPEX 1-1/2" | ProPEX 1-1/4" | ProPEX 3/4"   | No | - |
| ProPEX EP Reducing Tee, 1 1/2" PEX x 1 1/4" PEX x 1" PEX     | Q4751531 | 36.4 | Engineered Polymer | 11.2 | ProPEX 1-1/2" | ProPEX 1-1/4" | ProPEX 1"     | No | - |
| ProPEX EP Reducing Tee, 1 1/2" PEX x 1 1/4" PEX x 1 1/4" PEX | Q4751533 | 45.4 | Engineered Polymer | 17   | ProPEX 1-1/2" | ProPEX 1-1/4" | ProPEX 1-1/4" | No | - |
| ProPEX EP Reducing Tee, 1 1/2" PEX x 1 1/2" PEX x 1/2" PEX   | Q4751550 | 60.5 | Engineered Polymer | 3.4  | ProPEX 1-1/2" | ProPEX 1-1/2" | ProPEX 1/2"   | -  | - |
| ProPEX EP Reducing Tee, 1 1/2" PEX x 1 1/2" PEX x 3/4" PEX   | Q4751557 | 56   | Engineered Polymer | 9    | ProPEX 1-1/2" | ProPEX 1-1/2" | ProPEX 3/4"   | -  | - |
| ProPEX EP Reducing Tee, 1 1/2" PEX x 1 1/2" PEX x 1" PEX     | Q4751551 | 53.8 | Engineered Polymer | 15.3 | ProPEX 1-1/2" | ProPEX 1-1/2" | ProPEX 1"     | No | - |
| ProPEX EP Reducing Tee, 1 1/2" PEX x 1 1/2" PEX x 1 1/4" PEX | Q4751553 | 54.3 | Engineered Polymer | 33.7 | ProPEX 1-1/2" | ProPEX 1-1/2" | ProPEX 1-1/4" | -  | - |
| ProPEX EP Reducing Tee, 3/4" PEX x 1/2" PEX x 3/4" PEX       | Q4757557 | 5.4  | Engineered Polymer | 5.4  | ProPEX 3/4"   | ProPEX 1/2"   | ProPEX 3/4"   | -  | - |
| ProPEX EP Reducing Tee, 1" PEX x 1" PEX x 1 1/4" PEX         | Q4751113 | 15   | Engineered Polymer | 28   | ProPEX 1"     | ProPEX 1"     | ProPEX 1-1/4" | -  | - |
| ProPEX EP Reducing Tee, 1 1/4" PEX x 3/4" PEX x 1" PEX       | Q4751371 | 13.9 | -                  | 12.1 | ProPEX 1-1/4" | ProPEX 3/4"   | ProPEX 1"     | -  | - |
| ProPEX EP Reducing Tee, 1 1/4" PEX x 3/4" PEX x 1 1/4" PEX   | Q4751373 | 18.8 | -                  | 12   | ProPEX 1-1/4" | ProPEX 3/4"   | ProPEX 1-1/4" | -  | - |
| ProPEX EP Reducing Tee, 1 1/4" PEX x 3/4" PEX x 3/4" PEX     | Q4751377 | 7.3  | -                  | 12   | ProPEX 1-1/4" | ProPEX 3/4"   | ProPEX 3/4"   | -  | - |
| ProPEX EP Reducing Tee, 1" PEX x 1/2" PEX x 1" PEX           | Q4751501 | 12.3 | Engineered Polymer | 5.7  | ProPEX 1"     | ProPEX 1/2"   | ProPEX 1"     | -  | - |
| ProPEX EP Reducing Tee, 1 1/2" PEX x 3/4" PEX x 1 1/2" PEX   | Q4751575 | 22.9 | -                  | 12   | ProPEX 1-1/2" | ProPEX 3/4"   | ProPEX 1-1/2" | -  | - |
| ProPEX EP Reducing Tee, 1 1/2" PEX x 3/4" PEX x 3/4" PEX     | Q4751577 | 7.3  | -                  | 11.7 | ProPEX 1-1/2" | ProPEX 3/4"   | ProPEX 3/4"   | -  | - |
| ProPEX EP Reducing Tee, 1" PEX x 3/4" PEX x 1/2" PEX         | Q4751750 | 3.1  | Engineered Polymer | 13.2 | ProPEX 1"     | ProPEX 3/4"   | ProPEX 1/2"   | -  | - |
| ProPEX EP Reducing Tee, 1" PEX x 3/4" PEX x 1 1/4" PEX       | Q4751753 | 14.7 | Engineered Polymer | 12   | ProPEX 1"     | ProPEX 3/4"   | ProPEX 1-1/4" | -  | - |

| Nom de la pièce   | Numéro de pièce | Les codes                             | Normes   | Annexes   |
|---|-----------------|---------------------------------------|--|---|
| Tés réducteurs ProPEX en EP - jusqu'à 1,5 po                                    | All             | IMC UPC IBC IRC IPC NPC of Canada UMC | ASTM F1960 ASTM E119/UL 263 ASTM E84 ASTM E814/ULC S115 ASTM F877 CSA B137.5 ULC S102.2 NSF/ANSI/CAN 61 ULC S101 NSF/ANSI 14 | IAPMO-ES ICC-ES-PMG UL U.P.Code cQA us P321 HUD MR 1269 |
| In addition, the following parts have additional codes, standards, or listings: |                 |                                       |  |   |
| ProPEX EP Reducing Tee, 1/2" PEX x 1/2" PEX x 3/4" PEX                          | Q4755575        | NSPC                                  |  | cNSFus-pw   |
| ProPEX EP Reducing Tee, 3/4" PEX x 1/2" PEX x 1/2" PEX                          | Q4757555        | NSPC                                  |  | cNSFus-pw   |
| ProPEX EP Reducing Tee, 3/4" PEX x 3/4" PEX x 1/2" PEX                          | Q4757550        | NSPC                                  | UL 1821  | cNSFus-pw-fs  |
| ProPEX EP Reducing Tee, 3/4" PEX x 3/4" PEX x 5/8" PEX                          | Q4757563        | NSPC                                  |  | cNSFus-pw   |
| ProPEX EP Reducing Tee, 3/4" PEX x 3/4" PEX x 1" PEX                            | Q4757710        | NSPC                                  | UL 1821  | cNSFus-pw-fs  |
| ProPEX EP Reducing Tee, 1" PEX x 3/4" PEX x 3/4" PEX                            | Q4751775        |                                       |  | cNSFus-pw-fs  |
| ProPEX EP Reducing Tee, 1" PEX x 3/4" PEX x 1" PEX                              | Q4751751        |                                       |  | cNSFus-pw-fs  |
| ProPEX EP Reducing Tee, 1" PEX x 1" PEX x 1/2" PEX                              | Q4751150        | NSPC                                  | UL 1821  | cNSFus-pw-fs  |
| ProPEX EP Reducing Tee, 1" PEX x 1" PEX x 3/4" PEX                              | Q4751175        | NSPC                                  | UL 1821  | cNSFus-pw-fs  |
| ProPEX EP Reducing Tee, 1 1/4" PEX x 1" PEX x 3/4" PEX                          | Q4751317        | NSPC                                  | UL 1821  | cNSFus-pw-fs  |
| ProPEX EP Reducing Tee, 1 1/4" PEX x 1" PEX x 1" PEX                            | Q4751311        | NSPC                                  | UL 1821  | cNSFus-pw-fs  |
| ProPEX EP Reducing Tee, 1 1/4" PEX x 1 1/4" PEX x 1/2" PEX                      | Q4751350        | NSPC                                  | UL 1821  | cNSFus-pw-fs  |
| ProPEX EP Reducing Tee, 1 1/4" PEX x 1 1/4" PEX x 3/4" PEX                      | Q4751337        | NSPC                                  | UL 1821  | cNSFus-pw-fs  |
| ProPEX EP Reducing Tee, 1 1/4" PEX  | Q4751331        | NSPC                                  | UL 1821  | cNSFus-pw-fs  |

|  |          |      |         |              |
|--|----------|------|---------|--------------|
| x 1 1/4" PEX x 1" PEX  |          |      |         |              |
| ProPEX EP Reducing Tee, 1 1/2" PEX x 1" PEX x 3/4" PEX       | Q4751517 | NSPC |         | cNSFus-pw    |
| ProPEX EP Reducing Tee, 1 1/2" PEX x 1" PEX x 1" PEX         | Q4751511 | NSPC |         | cNSFus-pw    |
| ProPEX EP Reducing Tee, 1 1/2" PEX x 1" PEX x 1 1/2" PEX     | Q4751505 | NSPC |         | cNSFus-pw    |
| ProPEX EP Reducing Tee, 1 1/2" PEX x 1 1/4" PEX x 3/4" PEX   | Q4751537 | NSPC |         | cNSFus-pw    |
| ProPEX EP Reducing Tee, 1 1/2" PEX x 1 1/4" PEX x 1" PEX     | Q4751531 | NSPC |         | cNSFus-pw    |
| ProPEX EP Reducing Tee, 1 1/2" PEX x 1 1/4" PEX x 1 1/4" PEX | Q4751533 | NSPC |         | cNSFus-pw    |
| ProPEX EP Reducing Tee, 1 1/2" PEX x 1 1/2" PEX x 1/2" PEX   | Q4751550 | NSPC |         | cNSFus-pw    |
| ProPEX EP Reducing Tee, 1 1/2" PEX x 1 1/2" PEX x 3/4" PEX   | Q4751557 | NSPC |         | cNSFus-pw    |
| ProPEX EP Reducing Tee, 1 1/2" PEX x 1 1/2" PEX x 1" PEX     | Q4751551 | NSPC |         | cNSFus-pw    |
| ProPEX EP Reducing Tee, 1 1/2" PEX x 1 1/2" PEX x 1 1/4" PEX | Q4751553 | NSPC |         | cNSFus-pw    |
| ProPEX EP Reducing Tee, 3/4" PEX x 1/2" PEX x 3/4" PEX       | Q4757557 | NSPC | UL 1821 | cNSFus-pw-fs |
| ProPEX EP Reducing Tee, 1" PEX x 1" PEX x 1 1/4" PEX         | Q4751113 | NSPC | UL 1821 | cNSFus-pw-fs |
| ProPEX EP Reducing Tee, 1 1/4" PEX x 3/4" PEX x 1" PEX       | Q4751371 | NSPC | UL 1821 | cNSFus-pw-fs |
| ProPEX EP Reducing Tee, 1 1/4" PEX x 3/4" PEX x 1 1/4" PEX   | Q4751373 | NSPC | UL 1821 | cNSFus-pw-fs |
| ProPEX EP Reducing Tee, 1 1/4" PEX x 3/4" PEX x 3/4" PEX     | Q4751377 | NSPC | UL 1821 | cNSFus-pw-fs |
| ProPEX EP Reducing Tee, 1" PEX x 1/2" PEX x 1" PEX           | Q4751501 | NSPC |         | cNSFus-pw    |
| ProPEX EP Reducing Tee, 1 1/2" PEX x 3/4" PEX x 1 1/2" PEX   | Q4751575 |      | UL 1821 | cNSFus-pw    |
| ProPEX EP Reducing Tee, 1 1/2" PEX x 3/4" PEX x 3/4" PEX     | Q4751577 |      | UL 1821 | cNSFus-pw    |
| ProPEX EP Reducing Tee, 1" PEX x 3/4" PEX x 1/2" PEX         | Q4751750 | NSPC |         | cNSFus-pw    |
| ProPEX EP Reducing Tee, 1" PEX x 3/4" PEX x 1 1/4" PEX       | Q4751753 | NSPC |         | cNSFus-pw    |

#### L'installation

Use the appropriate ProPEX ring for PEX-a tubing. Refer to the Uponor Piping Pocket Guide, AquaSAFE™ Residential Fire Sprinkler Installation Guide or Uponor Radiant Installation Handbook for additional information.

#### Applications connexes

PEX-a Plumbing Systems  
Hydronic Radiant Heating and Cooling Systems  
Turf Conditioning Systems  
Permafrost Prevention Systems

#### Notes de bas de page

#### Coordonnées de la personne-ressource

Uponor Inc.  
5925 148th Street West  
Apple Valley, MN 55124  
T 800.321.4739  
F 952.891.2008

Uponor Ltd.  
6510 Kennedy Road  
Mississauga, ON L5T 2X4  
T 888.594.7726  
F 800.638.9517