

Tés réducteurs ProPEX en EP - jusqu'à 1,5 po

Renseignements sur le projet

Nom du poste :	Lieu :
Ingénieur :	Date de soumission:
Entrepreneur :	Présentée par:
Représentant du fabricant :	Approuvé par :

Données techniques

Temp/pressure ratings	73 °F (23 °C) at 160 psi (11 bar)
	180 °F (82 °C) at 100 psi (6.9 bar)
	200 °F (93 °C) at 80 psi (5.5 bar)

Informations sur le produit et utilisation de l'application

ProPEX® engineered polymer (EP) reducing tees make diverting connections for Uponor crosslinked polyethylene (PEX-a) tubing for use in hot and cold domestic potable water systems, residential fire sprinkler systems and hydronic radiant heating and cooling systems. Each end of the tee is manufactured with an Uponor ProPEX fitting for connections to Uponor AquaPEX® or Wirsbo hePEX™ tubing. 1 Note: Branch size is listed last in the part descriptions.

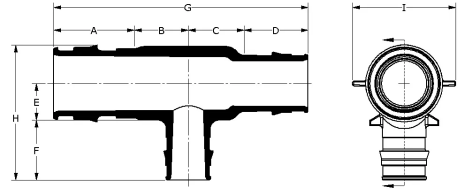

Related: [ProPEX EP reducing tees - 2in and up](#)

Note: Temperature and pressure ratings stated are hydrostatic ratings. For domestic hot-water (DHW) and DHW recirculation installations, operating conditions should not exceed 140°F (60°C) at 80 psi (5.5 bar) in accordance with ASTM F2023. For additional information regarding application-specific temperature and pressure ratings, refer to the Uponor PEX Piping Systems Design and Installation Manual.

Nom de la pièce	Numéro de pièce	Cv Through	Material group	Cv Branch	End Type 1	End Type 2	End Type 3	Prop 65 label required?	Cv
ProPEX EP Reducing Tee, 1/2" PEX x 1/2" PEX x 3/4" PEX	Q4755575	7.7	Engineered Polymer	5.4	ProPEX 1/2"	ProPEX 1/2"	ProPEX 3/4"	-	-
ProPEX EP Reducing Tee, 3/4" PEX x 1/2" PEX x 1/2" PEX	Q4757555	4.6	Engineered Polymer	3.4	ProPEX 3/4"	ProPEX 1/2"	ProPEX 1/2"	-	-
ProPEX EP Reducing Tee, 3/4" PEX x 3/4" PEX x 1/2" PEX	Q4757550	14.2	Engineered Polymer	3.1	ProPEX 3/4"	ProPEX 3/4"	ProPEX 1/2"	-	-
ProPEX EP Reducing Tee, 3/4" PEX x 3/4" PEX x 5/8" PEX	Q4757563	15.7	Engineered Polymer	5.4	ProPEX 3/4"	ProPEX 3/4"	ProPEX 5/8"	-	-
ProPEX EP Reducing Tee, 3/4" PEX x 3/4" PEX x 1" PEX	Q4757710	15.7	Engineered Polymer	8.7	ProPEX 3/4"	ProPEX 3/4"	ProPEX 1"	-	2.6
ProPEX EP Reducing Tee, 1" PEX x 3/4" PEX x 3/4" PEX	Q4751775	12.8	Engineered Polymer	5.3	ProPEX 1"	ProPEX 3/4"	ProPEX 3/4"	-	-
ProPEX EP Reducing Tee, 1" PEX x 3/4" PEX x 1" PEX	Q4751751	12.9	Engineered Polymer	10.5	ProPEX 1"	ProPEX 3/4"	ProPEX 1"	-	-
ProPEX EP Reducing Tee, 1" PEX x 1" PEX x 1/2" PEX	Q4751150	32.2	Engineered Polymer	3.4	ProPEX 1"	ProPEX 1"	ProPEX 1/2"	-	-
ProPEX EP Reducing Tee, 1" PEX x 1" PEX x 3/4" PEX	Q4751175	27.8	Engineered Polymer	8.2	ProPEX 1"	ProPEX 1"	ProPEX 3/4"	-	-
ProPEX EP Reducing Tee, 1 1/4" PEX x 1" PEX x 3/4" PEX	Q4751317	21	Engineered Polymer	9.3	ProPEX 1-1/4"	ProPEX 1"	ProPEX 3/4"	-	-
ProPEX EP Reducing Tee, 1 1/4" PEX x 1" PEX x 1" PEX	Q4751311	11.7	Engineered Polymer	8.4	ProPEX 1-1/4"	ProPEX 1"	ProPEX 1"	-	-
ProPEX EP Reducing Tee, 1 1/4" PEX x 1 1/4" PEX x 1/2" PEX	Q4751350	45.2	Engineered Polymer	4.1	ProPEX 1-1/4"	ProPEX 1-1/4"	ProPEX 1/2"	-	-
ProPEX EP Reducing Tee, 1 1/4" PEX x 1 1/4" PEX x 3/4" PEX	Q4751337	43.4	Engineered Polymer	8.9	ProPEX 1-1/4"	ProPEX 1-1/4"	ProPEX 3/4"	-	-
ProPEX EP Reducing Tee, 1 1/4" PEX x 1 1/4" PEX x 1" PEX	Q4751331	33	Engineered Polymer	15.8	ProPEX 1-1/4"	ProPEX 1-1/4"	ProPEX 1"	No	-
ProPEX EP Reducing Tee, 1 1/2" PEX x 1" PEX x 3/4" PEX	Q4751517	19.5	Engineered Polymer	9.3	ProPEX 1-1/2"	ProPEX 1"	ProPEX 3/4"	-	-
ProPEX EP Reducing Tee, 1 1/2" PEX x 1" PEX x 1" PEX	Q4751511	18.9	Engineered Polymer	15.6	ProPEX 1-1/2"	ProPEX 1"	ProPEX 1"	-	-
ProPEX EP Reducing Tee, 1 1/2" PEX x 1" PEX x 1 1/2" PEX	Q4751505	19	Engineered Polymer	26.5	ProPEX 1-1/2"	ProPEX 1"	ProPEX 1-1/2"	-	-

ProPEX EP Reducing Tee, 1 1/2" PEX x 1 1/4" PEX x 3/4" PEX	Q4751537	33.1	Engineered Polymer	6.3	ProPEX 1-1/2"	ProPEX 1-1/4"	ProPEX 3/4"	No	-
ProPEX EP Reducing Tee, 1 1/2" PEX x 1 1/4" PEX x 1" PEX	Q4751531	36.4	Engineered Polymer	11.2	ProPEX 1-1/2"	ProPEX 1-1/4"	ProPEX 1"	No	-
ProPEX EP Reducing Tee, 1 1/2" PEX x 1 1/4" PEX x 1 1/4" PEX	Q4751533	45.4	Engineered Polymer	17	ProPEX 1-1/2"	ProPEX 1-1/4"	ProPEX 1-1/4"	No	-
ProPEX EP Reducing Tee, 1 1/2" PEX x 1 1/2" PEX x 1/2" PEX	Q4751550	60.5	Engineered Polymer	3.4	ProPEX 1-1/2"	ProPEX 1-1/2"	ProPEX 1/2"	-	-
ProPEX EP Reducing Tee, 1 1/2" PEX x 1 1/2" PEX x 3/4" PEX	Q4751557	56	Engineered Polymer	9	ProPEX 1-1/2"	ProPEX 1-1/2"	ProPEX 3/4"	-	-
ProPEX EP Reducing Tee, 1 1/2" PEX x 1 1/2" PEX x 1" PEX	Q4751551	53.8	Engineered Polymer	15.3	ProPEX 1-1/2"	ProPEX 1-1/2"	ProPEX 1"	No	-
ProPEX EP Reducing Tee, 1 1/2" PEX x 1 1/2" PEX x 1 1/4" PEX	Q4751553	54.3	Engineered Polymer	33.7	ProPEX 1-1/2"	ProPEX 1-1/2"	ProPEX 1-1/4"	-	-
ProPEX EP Reducing Tee, 3/4" PEX x 1/2" PEX x 3/4" PEX	Q4757557	5.4	Engineered Polymer	5.4	ProPEX 3/4"	ProPEX 1/2"	ProPEX 3/4"	-	-
ProPEX EP Reducing Tee, 1" PEX x 1" PEX x 1 1/4" PEX	Q4751113	15	Engineered Polymer	28	ProPEX 1"	ProPEX 1"	ProPEX 1-1/4"	-	-
ProPEX EP Reducing Tee, 1 1/4" PEX x 3/4" PEX x 1" PEX	Q4751371	13.9	-	12.1	ProPEX 1-1/4"	ProPEX 3/4"	ProPEX 1"	-	-
ProPEX EP Reducing Tee, 1 1/4" PEX x 3/4" PEX x 1 1/4" PEX	Q4751373	18.8	-	12	ProPEX 1-1/4"	ProPEX 3/4"	ProPEX 1-1/4"	-	-
ProPEX EP Reducing Tee, 1 1/4" PEX x 3/4" PEX x 3/4" PEX	Q4751377	7.3	-	12	ProPEX 1-1/4"	ProPEX 3/4"	ProPEX 3/4"	-	-
ProPEX EP Reducing Tee, 1" PEX x 1/2" PEX x 1" PEX	Q4751501	12.3	Engineered Polymer	5.7	ProPEX 1"	ProPEX 1/2"	ProPEX 1"	-	-
ProPEX EP Reducing Tee, 1 1/2" PEX x 3/4" PEX x 1 1/2" PEX	Q4751575	22.9	-	12	ProPEX 1-1/2"	ProPEX 3/4"	ProPEX 1-1/2"	-	-
ProPEX EP Reducing Tee, 1 1/2" PEX x 3/4" PEX x 3/4" PEX	Q4751577	7.3	-	11.7	ProPEX 1-1/2"	ProPEX 3/4"	ProPEX 3/4"	-	-
ProPEX EP Reducing Tee, 1" PEX x 3/4" PEX x 1/2" PEX	Q4751750	3.1	Engineered Polymer	13.2	ProPEX 1"	ProPEX 3/4"	ProPEX 1/2"	-	-
ProPEX EP Reducing Tee, 1" PEX x 3/4" PEX x 1 1/4" PEX	Q4751753	14.7	Engineered Polymer	12	ProPEX 1"	ProPEX 3/4"	ProPEX 1-1/4"	-	-

Nom de la pièce	Numéro de pièce	Les codes	Normes	Annexes
Tés réducteurs ProPEX en EP - jusqu'à 1,5 po	All	IMC UPC IBC IRC IPC NPC of Canada UMC	ASTM F1960 ASTM E119/UL 263 ASTM E84 ASTM E814/ULC S115 ASTM F877 CSA B137.5 ULC S102.2 NSF/ANSI/CAN 61 ULC S101 NSF/ANSI 14	IAPMO-ES ICC-ES-PMG UL U.P.Code cQA us P321 HUD MR 1269
In addition, the following parts have additional codes, standards, or listings:				
ProPEX EP Reducing Tee, 1/2" PEX x 1/2" PEX x 3/4" PEX	Q4755575	NSPC		cNSFus-pw
ProPEX EP Reducing Tee, 3/4" PEX x 1/2" PEX x 1/2" PEX	Q4757555	NSPC		cNSFus-pw
ProPEX EP Reducing Tee, 3/4" PEX x 3/4" PEX x 1/2" PEX	Q4757550	NSPC	UL 1821	cNSFus-pw-fs
ProPEX EP Reducing Tee, 3/4" PEX x 3/4" PEX x 5/8" PEX	Q4757563	NSPC		cNSFus-pw
ProPEX EP Reducing Tee, 3/4" PEX x 3/4" PEX x 1" PEX	Q4757710	NSPC	UL 1821	cNSFus-pw-fs
ProPEX EP Reducing Tee, 1" PEX x 3/4" PEX x 3/4" PEX	Q4751775			cNSFus-pw-fs
ProPEX EP Reducing Tee, 1" PEX x 3/4" PEX x 1" PEX	Q4751751			cNSFus-pw-fs
ProPEX EP Reducing Tee, 1" PEX x 1" PEX x 1/2" PEX	Q4751150	NSPC	UL 1821	cNSFus-pw-fs
ProPEX EP Reducing Tee, 1" PEX x 1" PEX x 3/4" PEX	Q4751175	NSPC	UL 1821	cNSFus-pw-fs
ProPEX EP Reducing Tee, 1 1/4" PEX x 1" PEX x 3/4" PEX	Q4751317	NSPC	UL 1821	cNSFus-pw-fs
ProPEX EP Reducing Tee, 1 1/4" PEX x 1" PEX x 1" PEX	Q4751311	NSPC	UL 1821	cNSFus-pw-fs
ProPEX EP Reducing Tee, 1 1/4" PEX x 1 1/4" PEX x 1/2" PEX	Q4751350	NSPC	UL 1821	cNSFus-pw-fs
ProPEX EP Reducing Tee, 1 1/4" PEX x 1 1/4" PEX x 3/4" PEX	Q4751337	NSPC	UL 1821	cNSFus-pw-fs
ProPEX EP Reducing Tee, 1 1/4" PEX	Q4751331	NSPC	UL 1821	cNSFus-pw-fs

x 1 1/4" PEX x 1" PEX				
ProPEX EP Reducing Tee, 1 1/2" PEX x 1" PEX x 3/4" PEX	Q4751517	NSPC		cNSFus-pw
ProPEX EP Reducing Tee, 1 1/2" PEX x 1" PEX x 1" PEX	Q4751511	NSPC		cNSFus-pw
ProPEX EP Reducing Tee, 1 1/2" PEX x 1" PEX x 1 1/2" PEX	Q4751505	NSPC		cNSFus-pw
ProPEX EP Reducing Tee, 1 1/2" PEX x 1 1/4" PEX x 3/4" PEX	Q4751537	NSPC		cNSFus-pw
ProPEX EP Reducing Tee, 1 1/2" PEX x 1 1/4" PEX x 1" PEX	Q4751531	NSPC		cNSFus-pw
ProPEX EP Reducing Tee, 1 1/2" PEX x 1 1/4" PEX x 1 1/4" PEX	Q4751533	NSPC		cNSFus-pw
ProPEX EP Reducing Tee, 1 1/2" PEX x 1 1/2" PEX x 1/2" PEX	Q4751550	NSPC		cNSFus-pw
ProPEX EP Reducing Tee, 1 1/2" PEX x 1 1/2" PEX x 3/4" PEX	Q4751557	NSPC		cNSFus-pw
ProPEX EP Reducing Tee, 1 1/2" PEX x 1 1/2" PEX x 1" PEX	Q4751551	NSPC		cNSFus-pw
ProPEX EP Reducing Tee, 1 1/2" PEX x 1 1/2" PEX x 1 1/4" PEX	Q4751553	NSPC		cNSFus-pw
ProPEX EP Reducing Tee, 3/4" PEX x 1/2" PEX x 3/4" PEX	Q4757557	NSPC	UL 1821	cNSFus-pw-fs
ProPEX EP Reducing Tee, 1" PEX x 1" PEX x 1 1/4" PEX	Q4751113	NSPC	UL 1821	cNSFus-pw-fs
ProPEX EP Reducing Tee, 1 1/4" PEX x 3/4" PEX x 1" PEX	Q4751371	NSPC	UL 1821	cNSFus-pw-fs
ProPEX EP Reducing Tee, 1 1/4" PEX x 3/4" PEX x 1 1/4" PEX	Q4751373	NSPC	UL 1821	cNSFus-pw-fs
ProPEX EP Reducing Tee, 1 1/4" PEX x 3/4" PEX x 3/4" PEX	Q4751377	NSPC	UL 1821	cNSFus-pw-fs
ProPEX EP Reducing Tee, 1" PEX x 1/2" PEX x 1" PEX	Q4751501	NSPC		cNSFus-pw
ProPEX EP Reducing Tee, 1 1/2" PEX x 3/4" PEX x 1 1/2" PEX	Q4751575		UL 1821	cNSFus-pw
ProPEX EP Reducing Tee, 1 1/2" PEX x 3/4" PEX x 3/4" PEX	Q4751577		UL 1821	cNSFus-pw
ProPEX EP Reducing Tee, 1" PEX x 3/4" PEX x 1/2" PEX	Q4751750	NSPC		cNSFus-pw
ProPEX EP Reducing Tee, 1" PEX x 3/4" PEX x 1 1/4" PEX	Q4751753	NSPC		cNSFus-pw

L'installation	Applications connexes
Use the appropriate ProPEX ring for PEX-a tubing. Refer to the Uponor Piping Pocket Guide, AquaSAFE™ Residential Fire Sprinkler Installation Guide or Uponor Radiant Installation Handbook for additional information.	PEX-a Plumbing Systems Hydronic Radiant Heating and Cooling Systems Turf Conditioning Systems Permafrost Prevention Systems

Notes de bas de page	Coordonnées de la personne-ressource
-	Uponor Inc. 5925 148th Street West Apple Valley, MN 55124 T 800.321.4739 F 952.891.2008
	Uponor Ltd. 6510 Kennedy Road Mississauga, ON L5T 2X4 T 888.594.7726 F 800.638.9517