

# Tés ProPEX en EP

## Renseignements sur le projet

Nom du poste :	Lieu :
Ingénieur :	Date de soumission:
Entrepreneur :	Présentée par:
Représentant du fabricant :	Approuvé par :

## Données techniques

Material	Engineered Polymer
Temp/pressure ratings	73 °F (23 °C) at 160 psi (11 bar) 180 °F (82 °C) at 100 psi (6.9 bar) 200 °F (93 °C) at 80 psi (5.5 bar)

## Informations sur le produit et utilisation de l'application

ProPEX® engineered polymer (EP) tees make diverting connections for Uponor crosslinked polyethylene (PEX-a) tubing for use in hot and cold domestic potable water systems, residential fire sprinkler systems and hydronic radiant heating and cooling systems. Each end of the tee is manufactured with an Uponor ProPEX fitting for connections to Uponor AquaPEX® or Wirsbo hePEX™ tubing.1 Note: Branch size is listed last in the part descriptions.

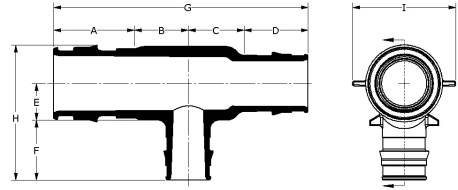

Note: Temperature and pressure ratings stated are hydrostatic ratings. For domestic hot-water (DHW) and DHW recirculation installations, operating conditions should not exceed 140°F (60°C) at 80 psi (5.5 bar) in accordance with ASTM F2023. For additional information regarding application-specific temperature and pressure ratings, refer to the Uponor PEX Piping Systems Design and Installation Manual.

Nom de la pièce	Numéro de pièce	A [inch]	B [inch]	C [inch]	D [inch]	E [inch]	F [inch]	G [inch]	H [inch]	I [inch]	Cv Through
ProPEX EP Tee, 1/2" PEX x 1/2" PEX x 1/2" PEX	Q4755050	0.719	0.58	0.58	0.719	0.4	0.719	2.598	1.428	0.87	7.7
ProPEX EP Tee, 3/4" PEX x 3/4" PEX x 3/4" PEX	Q4757575	0.955	0.7	0.7	0.955	0.52	0.955	3.31	1.475	1.22	15.7
ProPEX EP Tee, 1" PEX x 1" PEX x 1" PEX	Q4751010	1.191	0.925	0.925	1.191	0.65	1.191	4.232	2.431	1.48	30.5
ProPEX EP Tee, 1 1/4" PEX x 1 1/4" PEX x 1 1/4" PEX	Q4751313	1.455	1.15	1.15	1.455	0.85	1.455	5.21	2.986	1.82	34
ProPEX EP Tee, 1 1/2" PEX x 1 1/2" PEX x 1 1/2" PEX	Q4751515	1.714	1.2	1.2	1.714	0.85	1.714	5.828	3.314	2.07	63.7
ProPEX EP Tee, 2" PEX x 2" PEX x 2" PEX	Q4752000	2.157	1.75	1.75	2.157	1.05	2.157	7.814	4.247	2.82	150.7
ProPEX EP Tee, 2 1/2" PEX x 2 1/2" PEX x 2 1/2" PEX	Q4752500	2.83	2.45	2.45	2.83	1.33	2.83	10.56	5.45	3.6	197.2
ProPEX EP Tee, 3" PEX x 3" PEX x 3" PEX	Q4753000	3.38	2.75	2.75	3.38	1.45	3.38	12.26	6.367	4.2	286.6

Nom de la pièce	Numéro de pièce	Equivalent length branch [ft]	Equivalent length through [ft]	Cv Branch	End Type 1	End Type 2	End Type 3	Prop 65 label required?	Weight per UOM [lbs/UOM]
ProPEX EP Tee, 1/2" PEX x 1/2" PEX x 1/2" PEX	Q4755050	6.3	1	3.4	ProPEX 1/2"	ProPEX 1/2"	ProPEX 1/2"	-	0.02
ProPEX EP Tee, 3/4" PEX x 3/4" PEX x 3/4" PEX	Q4757575	15.6	1.5	5.4	ProPEX 3/4"	ProPEX 3/4"	ProPEX 3/4"	-	0.05
ProPEX EP Tee, 1" PEX x 1" PEX x 1" PEX	Q4751010	12.7	1.3	11.3	ProPEX 1"	ProPEX 1"	ProPEX 1"	-	0.07
ProPEX EP Tee, 1 1/4" PEX x 1 1/4" PEX x 1 1/4" PEX	Q4751313	8.6	3.8	23.9	ProPEX 1-1/4"	ProPEX 1-1/4"	ProPEX 1-1/4"	No	0.15
ProPEX EP Tee, 1 1/2" PEX x 1 1/2" PEX x 1 1/2" PEX	Q4751515	10.6	1.8	31	ProPEX 1-1/2"	ProPEX 1-1/2"	ProPEX 1-1/2"	No	0.25
ProPEX EP Tee, 2" PEX x 2" PEX x 2" PEX	Q4752000	15.5	0.8	52.5	ProPEX 2"	ProPEX 2"	ProPEX 2"	-	0.38
ProPEX EP Tee, 2 1/2" PEX x 2 1/2" PEX x 2 1/2" PEX	Q4752500	22.3	2.7	81.5	ProPEX 2-1/2"	ProPEX 2-1/2"	ProPEX 2-1/2"	-	1.14
ProPEX EP Tee, 3" PEX x 3" PEX x 3" PEX	Q4753000	23.9	2.8	122.8	ProPEX 3"	ProPEX 3"	ProPEX 3"	-	1.86

Nom de la pièce	Numéro de pièce	Les codes	Normes	Annonces
Tés ProPEX en EP	All	IMC UPC IBC IRC IPC NPC of Canada UMC NSPC	ASTM F1960 ASTM E119/UL 263 ASTM E84 ASTM E814/ULC S115 ASTM F877 CSA B137.5 JULC S102.2 NSF/ANSI/CAN 61 JULC S101 NSF/ANSI 14	IAPMO-ES ICC-ES-PMG UL U.P.Code cQAIus P321 HUD MR 1269
In addition, the following parts have additional codes, standards, or listings:				
ProPEX EP Tee, 1/2" PEX x 1/2" PEX x 1/2" PEX	Q4755050			cNSFus-pw
ProPEX EP Tee, 3/4" PEX x 3/4" PEX x 3/4" PEX	Q4757575		UL 1821	cNSFus-pw-fs
ProPEX EP Tee, 1" PEX x 1" PEX x 1" PEX	Q4751010		UL 1821	cNSFus-pw-fs
ProPEX EP Tee, 1 1/4" PEX x 1 1/4" PEX x 1 1/4" PEX	Q4751313		UL 1821	cNSFus-pw-fs
ProPEX EP Tee, 1 1/2" PEX x 1 1/2" PEX x 1 1/2" PEX	Q4751515			cNSFus-pw
ProPEX EP Tee, 2" PEX x 2" PEX x 2" PEX	Q4752000			cNSFus-pw
ProPEX EP Tee, 2 1/2" PEX x 2 1/2" PEX x 2 1/2" PEX	Q4752500		ASTM E814	cNSFus-pw
ProPEX EP Tee, 3" PEX x 3" PEX x 3" PEX	Q4753000			cNSFus-pw

L'installation	Applications connexes
Use the appropriate ProPEX Ring for PEX-a tubing. Refer to the Uponor Professional Plumbing Installation Guide, AquaSAFE™ Residential Fire Sprinkler Installation Guide or Uponor Radiant Installation Handbook for additional information	<ul style="list-style-type: none"> <li>PEX-a Plumbing Systems</li> <li>Hydronic Radiant Heating and Cooling Systems</li> <li>Turf Conditioning Systems</li> <li>Permafrost Prevention Systems</li> </ul>

Notes de bas de page	Coordonnées de la personne-ressource		
-	<table> <tr> <td>Uponor Inc. 5925 148th Street West Apple Valley, MN 55124 T 800.321.4739 F 952.891.2008</td> <td>Uponor Ltd. 6510 Kennedy Road Mississauga, ON L5T 2X4 T 888.594.7726 F 800.638.9517</td> </tr> </table>	Uponor Inc. 5925 148th Street West Apple Valley, MN 55124 T 800.321.4739 F 952.891.2008	Uponor Ltd. 6510 Kennedy Road Mississauga, ON L5T 2X4 T 888.594.7726 F 800.638.9517
Uponor Inc. 5925 148th Street West Apple Valley, MN 55124 T 800.321.4739 F 952.891.2008	Uponor Ltd. 6510 Kennedy Road Mississauga, ON L5T 2X4 T 888.594.7726 F 800.638.9517		