

# Accessoires pour collecteur à valve en cuivre - valve à bille et d'équilibrage ProPEX

## Renseignements sur le projet

|                             |                     |
|-----------------------------|---------------------|
| Nom du poste :              | Lieu :              |
| Ingénieur :                 | Date de soumission: |
| Entrepreneur :              | Présentée par:      |
| Représentant du fabricant : | Approuvé par :      |

## Données techniques

|                         |  |
|-------------------------|--|
| Material                | Brass  |
| Subcomponent Material   | CA 360 Brass   |
| End type 2              | Sweat 3/4"   |
| Cold working pressure   | 249.5 psi  |
| Temp/pressure ratings   | 73 °F (23 °C) at 160 psi (11 bar)<br>180 °F (82 °C) at 100 psi (6.9 bar)<br>200 °F (93 °C) at 80 psi (5.5 bar) |
| Prop 65 label required? | Yes  |

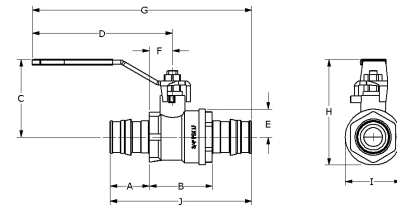

## Informations sur le produit et utilisation de l'application

The Uponor ProPEX® Ball and Balance Valve products feature in-line isolation valves.1

| Nom de la pièce   | Numéro de pièce | A [inch] | B [inch] | C [inch] | D [inch] | E [inch] | F [inch] | G [inch] | H [inch] | I [inch] | J [inch] |
|---|-----------------|----------|----------|----------|----------|----------|----------|----------|----------|----------|----------|
| ProPEX Ball and Balancing Valve, 5/8" PEX x 3/4" Copper Adapter | Q5906375        | 0.866    | 2.648    | 1.301    | 0.913    | 0.5      | 0.683    | 3.743    | 2.133    | 1        | 4.415    |
| ProPEX Ball and Balancing Valve, 3/4" PEX x 3/4" Copper Adapter | Q5907575        | 0.866    | 2.65     | 1.301    | 0.913    | 0.5      | 0.683    | 3.746    | 2.133    | 1        | 4.417    |

| Nom de la pièce   | Numéro de pièce | Cv  | End Type 1  | Weight per UOM [lbs/UOM] |
|---|-----------------|-----|-------------|--------------------------|
| ProPEX Ball and Balancing Valve, 5/8" PEX x 3/4" Copper Adapter | Q5906375        | 6.6 | ProPEX 5/8" | 0.8                      |
| ProPEX Ball and Balancing Valve, 3/4" PEX x 3/4" Copper Adapter | Q5907575        | 6.7 | ProPEX 3/4" | 0.8                      |

| Nom de la pièce   | Numéro de pièce | Les codes | Normes               | Annonces |
|---|-----------------|-----------|----------------------|----------|
| Accessoires pour collecteur à valve en cuivre - valve à bille et d'équilibrage ProPEX | All             | -         | ASTM F1960 ASTM F877 | -        |

## L'installation

Install valve according to local building code. Do not dismantle. If soldering, aim flame away from fitting. Remove safety cap. Using Allen key or hex wrench, fully close memory spindle by performing a complete clockwise turn and open it the required number of turns from the closed position. For balancing of manifolds, open the memory spindle fully for the longest loop and balance the other loops by setting their memory spindles according to their loop lengths relative to the longest loop. Refer to the Radiant Floor Installation Handbook for additional information.

## Applications connexes

PEX-a Plumbing Systems  
Radiant Heating and Cooling Systems  
Permafrost Protection Systems  
Turf Conditioning Systems

## Remarques :

Cv (Q5906375):

6.60

Cv (Q5907575): 6.70

## Notes de bas de page

## Coordonnées de la personne-ressource

Uponor Inc.  
5925 148th Street West  
Apple Valley, MN 55124  
T 800.321.4739  
F 952.891.2008

Uponor Ltd.  
6510 Kennedy Road  
Mississauga, ON L5T 2X4  
T 888.594.7726  
F 800.638.9517