

Adaptateurs ProPEX de raccord soudé à l'étain en laiton

Renseignements sur le projet

Nom du poste :	Lieu :
Ingénieur :	Date de soumission:
Entrepreneur :	Présentée par:
Représentant du fabricant :	Approuvé par :

Données techniques

Temp/pressure ratings	73 °F (23 °C) at 160 psi (11 bar)
	180 °F (82 °C) at 100 psi (6.9 bar)
	200 °F (93 °C) at 80 psi (5.5 bar)
Prop 65 label required?	Yes

Informations sur le produit et utilisation de l'application

ProPEX® brass sweat adapters transition Uponor PEX pipe to copper pipe for use in hydronic heating and cooling systems. 1 One end of the adapter is manufactured with the Uponor ProPEX fitting for connection to Wirsbo hePEX™ pipe and the other end is manufactured to adapt copper sweat connections. These adapters are not safe for direct burial in soil. Note: Not for potable use.

Note: Temperature and pressure ratings stated are hydrostatic ratings. For domestic hot-water (DHW) and DHW recirculation installations, operating conditions should not exceed 140°F (60°C) at 80 psi (5.5 bar) in accordance with ASTM F2023. For additional information regarding application-specific temperature and pressure ratings, refer to the Uponor PEX Piping Systems Design and Installation Manual.

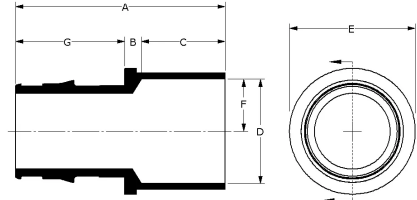

Nom de la pièce	Numéro de pièce	Cv	Material group	End Type 1	End Type 2
ProPEX LF Brass Sweat Adapter, 3/8" PEX x 1/2" Copper	LF4513850	5.7	LF Brass	ProPEX 3/8"	Sweat 1/2"
ProPEX Brass Sweat Adapter, 1/2" PEX x 1/2" Copper	Q5515050	5.7	Brass	ProPEX 1/2"	Sweat 1/2"
ProPEX LF Brass Sweat Adapter, 1/2" PEX x 3/4" Copper	LF4515075	5.1	LF Brass	ProPEX 1/2"	Sweat 3/4"
ProPEX Brass Sweat Adapter, 5/8" PEX x 1/2" Copper	Q4516350	-	Brass	ProPEX 5/8"	Sweat 1/2"
ProPEX Brass Sweat Adapter, 5/8" PEX x 3/4" Copper	Q4516375	-	Brass	ProPEX 5/8"	Sweat 3/4"
ProPEX Brass Sweat Adapter, 3/4" PEX x 1/2" Copper	Q5517550	8.8	Brass	ProPEX 3/4"	Sweat 1/2"
ProPEX Brass Sweat Adapter, 3/4" PEX x 3/4" Copper	Q5517575	13.4	Brass	ProPEX 3/4"	Sweat 3/4"
ProPEX Brass Sweat Adapter, 3/4" PEX x 1" Copper	Q5517510	10.9	Brass	ProPEX 3/4"	Sweat 1"
ProPEX Brass Sweat Adapter, 1" PEX x 1" Copper	Q5511010	22.1	Brass	ProPEX 1"	Sweat 1"
ProPEX Brass Sweat Adapter, 1 1/4" PEX x 1 1/4" Copper	Q5511313	34	Brass	ProPEX 1-1/4"	Sweat 1-1/4"
ProPEX Brass Sweat Adapter, 2" PEX x 2" Copper	Q5512020	83.6	Brass	ProPEX 2"	Sweat 2"
ProPEX LF Brass Sweat Adapter, 3" PEX x 3" Copper	LF4513030	189.1	LF Brass	ProPEX 3"	Sweat 3"
ProPEX Brass Sweat Adapter, 1 1/2" PEX x 1 1/2" Copper	Q5511515	45.5	Brass	ProPEX 1-1/2"	Sweat 1-1/2"

Nom de la pièce	Numéro de pièce	Les codes	Normes	Annonces
Adaptateurs ProPEX de raccord soudé à l'étain en laiton	All	IBC IRC NPC of Canada UMC IMC	ASTM F877 ASTM F1960 CSA B137.5	IAPMO-ES ICC-ES-PMG
In addition, the following parts have additional codes, standards, or listings:				
ProPEX LF Brass Sweat Adapter, 3/8" PEX x 1/2" Copper	LF4513850	UPC IPC NSPC	NSF/ANSI/CAN 372 NSF/ANSI/CAN 61 NSF/ANSI 14	cNSFus-pw-G U.P.Code
ProPEX Brass Sweat Adapter, 1/2" PEX x 1/2" Copper	Q5515050		NSF-14	cNSFus-rfh
ProPEX LF Brass Sweat Adapter, 1/2" PEX x 3/4" Copper	LF4515075	UPC IPC NSPC	NSF/ANSI/CAN 372 NSF/ANSI/CAN 61 NSF/ANSI 14	cNSFus-pw-G U.P.Code
ProPEX Brass Sweat Adapter, 5/8" PEX x 1/2" Copper	Q4516350		NSF/ANSI 14	cNSFus-rfh
ProPEX Brass Sweat Adapter, 5/8" PEX x 3/4" Copper	Q4516375		NSF/ANSI 14	cNSFus-rfh
ProPEX Brass Sweat Adapter, 3/4" PEX x 1/2" Copper	Q5517550		NSF/ANSI 14	cNSFus-rfh
ProPEX Brass Sweat Adapter, 3/4" PEX x 3/4" Copper	Q5517575		NSF/ANSI 14	cNSFus-rfh
ProPEX Brass Sweat Adapter, 3/4" PEX x 1" Copper	Q5517510		NSF-14	cNSFus-rfh
ProPEX Brass Sweat Adapter, 1" PEX x 1" Copper	Q5511010		NSF/ANSI 14	cNSFus-rfh
ProPEX Brass Sweat Adapter, 1 1/4" PEX x 1 1/4" Copper	Q5511313		NSF-14	cNSFus-rfh
ProPEX Brass Sweat Adapter, 2" PEX x 2" Copper	Q5512020		NSF-14	cNSFus-rfh
ProPEX LF Brass Sweat Adapter, 3" PEX x 3" Copper	LF4513030	UPC IPC NSPC	NSF/ANSI/CAN 372 NSF/ANSI/CAN 61 NSF/ANSI 14	cNSFus-pw-G U.P.Code
ProPEX Brass Sweat Adapter, 1 1/2" PEX x 1 1/2" Copper	Q5511515		NSF-14	cNSFus-rfh

L'installation

Use the appropriate Uponor ProPEX ring for the pipe (sold separately). Do not solder within 18" of the ProPEX fitting. Refer to the Radiant Floor Heating Installation Handbook, Complete Design Assistance Manual (CDAM), or the Hydronic Piping Design Assistance Manual (HPDAM) for additional information.

Applications connexes

Radiant Heating and Cooling Systems
 Permafrost Protection Systems
 Turf Conditioning Systems
 Hydronic Piping Systems

Notes de bas de page

Coordonnées de la personne-ressource

-

Uponor Inc.
 5925 148th Street West
 Apple Valley, MN 55124
 T 800.321.4739
 F 952.891.2008

Uponor Ltd.
 6510 Kennedy Road
 Mississauga, ON L5T 2X4
 T 888.594.7726
 F 800.638.9517