

SELF-ASSEMBLY CABINETS FOR HEATING SYSTEM MANIFOLDS

NEW

ASSEMBLE-AND-GO SYSTEMS

OUR CABINETS CAN BE ASSEMBLED IN LESS THAN **1 MINUTE**

EASY AND QUICK CABINET ASSEMBLY

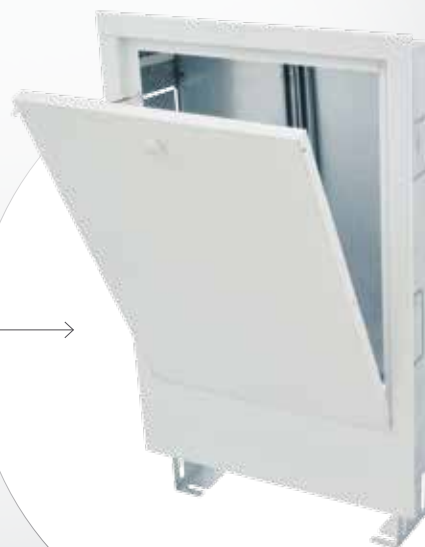
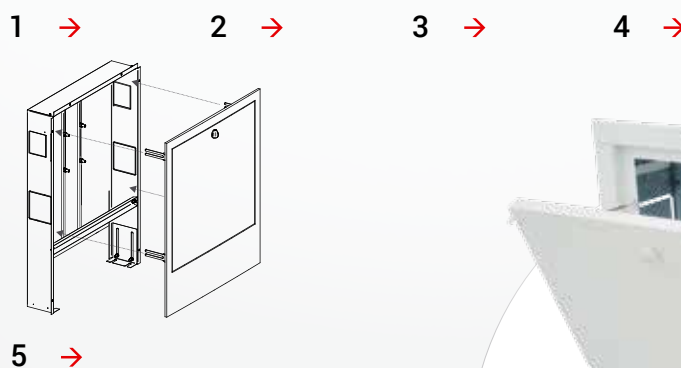
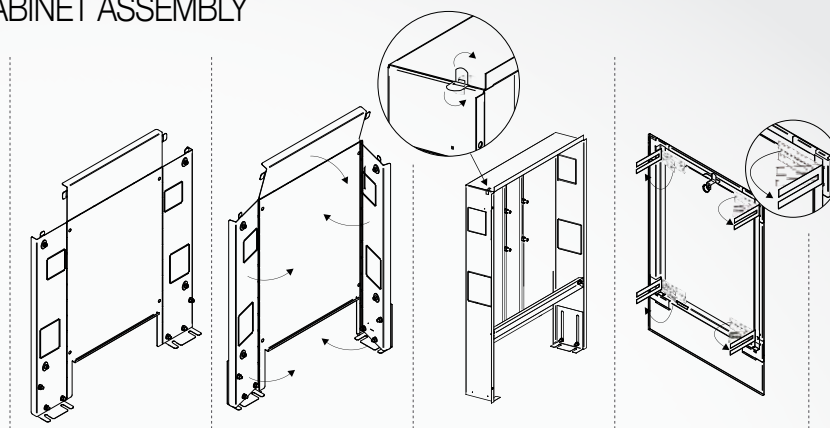

Cabinet size	Pallet quantity
350	60
450	45
600	40
750	30
900	30
1030	25
1130	20

**Minimum footprint
Maximum satisfaction**

READY
FOR MOUNTING
ON THE WALL



Capricorn S.A., ul. Ciernie 11, 58-160 Świebodzice,
Sales Department, tel. +48 74 8503 554, tel. +48 74 8503 546

www.capricorn.pl
sales@capricorn.pl

WIDE RANGE OF SURFACE-MOUNTED AND FLUSH-MOUNTED CABINETS

- CABINETS FOR MANIFOLDS
WITH AND WITHOUT MIXING STATIONS
- FULL RANGE OF SIZES:
350 TO 1130 MM
- AVAILABLE DEPTHS:
82 TO 165 MM
- Protected against corrosion
- We offer metal flush- and surface-mounted cabinets (powder-coated and zinc-plated)
- top quality paint coating
- Quality guaranteed by the thickest possible powder coating
- Robust and durable design based on the highest quality sheet metal used for manufacturing
- Easy and quick assembly ensures a functional installation procedure



UNDER PLASTER



OVER PLASTER

AVAILABLE LOCKS:



Plastic
lock



Key-operated
lock



Coin-operated
lock

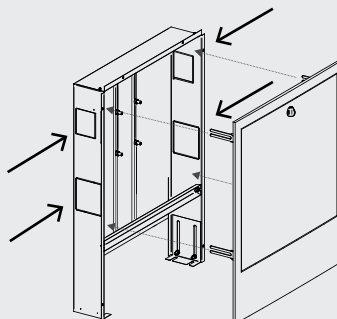

BRAND-GUARANTEED QUALITY

