

TotalFit™ Push-to-Connect Fitting System

Instruction Sheet

TotalFit™ is the professional-grade engineered polymer (EP) push-to-connect solution that provides greater value for residential projects with the same versatility and speed as brass push-to-connect fittings for PEX, PE-RT, CPVC, and copper piping systems.

Use Uponor TotalFit push-to-connect fittings to repair potable hot-water and cold-water distribution piping systems in single-family homes, townhomes, apartments, and condominiums.

Making a TotalFit Connection

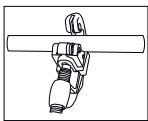

1. Square cut the piping perpendicular to the length of the pipe.

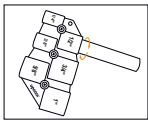

2. Remove excess material or burrs using the deburr and depth tool.

Important! Be sure to protect the pipe from nicks, scratches, and gouges during install as those can affect the integrity of the fitting connection.

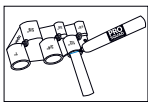

3. Continue using the deburr and depth tool to mark the appropriate insertion depth on the pipe. Below are the recommended depths.

- ½": 0.875" (7/8")
- ¾": 1"
- 1": 1.125" (1 1/8")

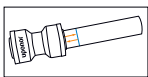

4. If using flexible PEX or PE-RT, install the insert inside the pipe first before making the connection. The insert provides added strength to the connection for flexible pipe.

Note: Failure to use the insert will void the warranty.

Important! The PEX/PE-RT insert adds about 1/16" to the pipe length. Keep this in mind when making the insertion depth marking on PEX and PE-RT pipe.

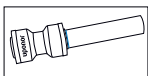

5. Insert the pipe into the fitting.

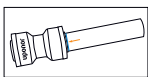

6. Confirm the fitting is fully inserted by aligning the edge of the fitting depth mark on the pipe.

Removing a TotalFit Connection

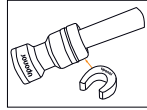

1. Attach the appropriately sized removal tool to the pipe
2. Press it back against the release collar on the fitting. This will disengage the grab ring.
3. Remove the pipe from the fitting.

Important! Be sure to inspect the fitting for any damage before using it on a future connection. Also, while it is acceptable to disconnect and reuse TotalFit push-to-connect fittings, Uponor does not recommend installing fittings with repeated reuse in permanent applications.

Installation and Application Guidelines

In Slab, Direct Burial, or Behind Walls

TotalFit push-to-connect fittings are approved by the Uniform Plumbing Code and International Plumbing Code for installation in a concrete slab, direct burial in the soil, and behind walls without access panels. For direct burial in soil or concrete, cover the fittings with 4 to 6 mil poly wrap.

Tub and Shower Valve Repairs

TotalFit is approved for use in repairing tub and shower downspouts. However, **do not** use PEX or PE-RT in this application as it may create excessive back pressure. This will cause the valve to remain slightly open, causing the shower head to drip water while using the tub spout.

Hot-water Heater Connections

TotalFit and Uponor AquaPEX® pipe are approved for installation directly to electric water heaters as well as power-vented gas water heaters (where allowed by local code). However, **do not** install TotalFit or Uponor AquaPEX pipe within 6" (15.2 cm) of a vent pipe for direct or gravity-vented appliances. Be sure to maintain a minimum 1" (25 mm) distance from double-wall B vents or zero-clearance plastic vents.

Spray-foam Insulation

Avoid any contact with spray-foam insulation. Cover the fittings with an overwrap of 4 to 6 mil poly or other suitable waterproof protection.

Chemical Compatibility

Do not use petroleum-based or solvent-based paints, greases, or sealants on TotalFit products, and do not expose to organic chemicals, strong acids, strong bases, or immerse in saltwater. Only use PTFE thread seal tape (with a minimum of three wraps) to seal male and female adapters. If using thread sealant paste in addition to tape, consult the paste manufacturer for compatibility with polymer fittings.

UV Exposure

TotalFit push-to-connect fittings are resistant to damage from UV light and do not require special care to protect from exposure. Always check the pipe manufacturers' installation guidelines for any additional safety precautions.

System Disinfection

When required, disinfect Uponor AquaPEX pipe and TotalFit push-to-connect fittings in accordance with local code and the AWWA C651 Standard, *Disinfecting Water Mains*.

General Guidelines

- Do not store outdoors; keep in the original packaging until ready for installation.
- Do not use to convey natural gas or compressed air.
- Do not use where temperatures and pressures exceed limits.
- Do not weld, glue, use adhesives, or adhesive tape.
- Do not solder, braze, weld, or fusion-weld within 18".
- Do not apply heat with a heat gun or open flame.
- Do not subject to blunt impact.
- Do not allow rodents, insects, or other pests to come into contact with the product.
- Do not expose to bending loads greater than 100 lbs.

Codes, Standards, and Listings

Uponor TotalFit push-to-connect fittings are designed and manufactured to all applicable industry codes, standards, and listings. However, be sure to check with your local water authority for compliance. For further details, refer to the product submittals on [uponor.com](https://www.uponor.com).

Listing: IAPMO

Codes: International Plumbing Code (IPC), Uniform Plumbing Code (UPC), and National Plumbing Code of Canada (NPCC)

Standards	
ASSE-1061	Standard specification for push-to-connect fittings
ASTM F876	Standard specification for cross-linked polyethylene (PEX) piping
ASTM F877	Standard specification for cross-linked polyethylene (PEX) plastic hot- and cold-water distribution system
CAN/CSA B137.5	Crosslinked polyethylene (PEX) piping systems for pressure applications
NSF/ANSI 14	Plastics piping system components and related materials ANSI/NSF
NSF/ANSI/CAN 61	Drinking water system components — health effects
NSF 372	Drinking water system components — lead content

Warranty

Uponor warrants TotalFit push-to-connect fittings shall be free from defects in material and workmanship for 25 years if used on Uponor or other manufacturers' pipe that complies with the below standards.

- PEX (a, b, or c) – ASTM F876 or CSA B137.5
- Copper (K, L, or M) – ASTM B88
- CPVC – ASTM D2846 or CSA B137.6
- PE-RT – ASTM F2769

Uponor Inc.

5925 148th Street West
Apple Valley, MN 55124 USA

T 800.321.4739

F 952.891.2008

Uponor Ltd.

6510 Kennedy Road
Mississauga, ON L5T 2X4 CANADA

T 888.594.7726

F 800.638.9517

Uponor

Moving > Forward