

Media Release

Frankfurt/Main, 17 March 2025

Renovations without limitations: the new Uponor Siccus 16 direct tiling dry underfloor radiant heating system for 40 % faster installation

The Uponor Siccus 16 dry underfloor radiant heating system allows direct flooring on the EPS board, eliminating several steps in installation. At the same time, its low installation height of just 20 mm and lightweight construction makes it a real problem-solver in the renovation sector, where installers often face three key challenges: limited installation height, complex assembly, and floor load restrictions. Uponor Siccus 16 provides optimal heating performance within only 20 minutes and is the ideal complement to low-temperature heat sources such as heat pumps.

As Europe prioritizes energy-efficient renovations over new builds, the construction industry faces challenges in upgrading existing buildings while maintaining structural integrity and meeting modern energy directives. Traditional underfloor heating systems require thick screeds, increasing installation height, structural load, and installation time, all issues that make retrofitting difficult. The demand to upgrade and extend the lifetime of existing buildings requires improved solutions. The Uponor Siccus 16 dry underfloor radiant heating system is designed to overcome these challenges. By enabling direct flooring installation, it eliminates unnecessary layers, reducing installation height, simplifying assembly, and cutting installation time by up to 40% by removing installation steps. Its lightweight construction ensures compatibility with floor load restrictions, making it the perfect solution for renovation projects.

Radiant renovation, reinvented

Where previously underfloor heating was not an option due to the structural conditions, the new Uponor Siccus 16 dry radiant heating system offers this possibility due to its extremely low installation height of just 20 millimeters (28 – 38 mm full flooring height depending on the final flooring) and its lightweight construction (2.5 kg / m² with pipes). „The innovation enables our specialist partners from the planning and sanitary installation sector to further expand their offer range in renovation projects. Now they can also take on renovation projects that previously could not be upgraded energy-efficiently with underfloor heating due to technical circumstances,” says Torsten Meier, Chief Innovation Officer, GF Building Flow Solutions.

Fast installation eliminating several steps

The Uponor Siccus 16 underfloor heating solution can be installed in dry method without heavy and high wet screed construction, which significantly reduces construction costs. Another advantage of the system is that installers can install the underfloor heating themselves (installation requires only one person) and without interruption. This makes the installation of the Uponor Siccus 16 system up to 40 % faster, and saves costs, too. The simplified assembly provides additional safety, because fewer work steps also mean fewer sources of error, and Uponor Siccus 16 therefore offers the highly efficient and risk-minimized installation of panel heating.

Comfort factor: reach the desired feel-good temperature faster

Radiant heating and cooling offer a high level of comfort. Uponor Siccus 16 underfloor heating ensures comfortable temperatures all year round. As the underfloor heating emits radiant heat, the heat is distributed evenly throughout the room. This ensures fewer draughts compared to conventional radiators or ventilation systems. Thanks to its proximity to the surface, the optimal heating performance is achievable in just 20 minutes.

Cooling is the new heating

The Uponor Siccus 16 panel heating system is a low-energy cooling solution due to its compatibility with heat pumps which can be used for cooling, too. Low-energy cooling solutions combined with high comfort are a growing demand, due to the changing climate, and being ahead of this development offers new business opportunities for installers. Uponor Siccus 16 is an efficient, universally applicable solution for a comfortable climate all year round.

Design freedom factor: room design without radiators

Uponor Siccus 16 gives planners and building owners more design options in the room: the heating is completely built into the floor so that the interior design does not have to be adapted to the heating system with traditional radiators, which take up space on the walls. "This is another major advantage of underfloor heating systems over traditional radiators: they require regular maintenance and cleaning to ensure adequate operation and have a significantly shorter service life of 20 to 30 years. As underfloor heating systems are operated at low temperatures and less pressure, they can function for around 40 to 50 years without any problems if operated properly," explains Torsten Meier. "This is not only cost-saving, but also sustainable."

Technical properties Uponor Siccus 16:

- Lightweight, compact panel with integrated aluminum heat distribution for dry construction
- Floor covering (tiles or laminate) can be laid directly on the EPS panel without an additional load distribution layer
- Low installation height of 20 millimetres (28 – 38 mm full flooring height depending on the final flooring)
- Quick installation: up to 40 % faster installation removing installation steps (can be installed by 1 person)
- Fast response time: optimal heating performance achievable in just 20 minutes



GF Building Flow Solutions @ ISH 2025
Leading with Water

Visit us:
Booth E07, hall 4.0
Frankfurt/Main, 17 – 21 March 2025

Media contact:

Beatrix Pfundstein
Manager Global PR & Communications
GF Building Flow Solutions
beatrix.pfundstein@uponor.com
+49 (0)69 795386015

About GF Building Flow Solutions – Leading with Water

With the construction industry accounting for a major part of the global CO2 emissions, and the need for clean and safe drinking water to serve a growing population, GF Building Flow Solutions' mission is to solve the challenges of our time: the increasing demand for energy-efficient and affordable buildings, inviting and safe homes as well as access to clean and safe drinking water. GF Building Flow Solutions is Leading with Water, unleashing water's great potential as a resource to make buildings better, facilitate progress and enable our customers to be more productive and sustainable, ensuring comfort, health, and efficiency. Combining the best of the industry-leading brands GF, Uponor, and JRG, based on trusted Swiss, Finnish and German quality under one umbrella, customers get access to the broadest technology platform for a wide range of applications, ensuring customer satisfaction and performance. The portfolio comprises of safe solutions for hot- and cold-water supply and control, noise-reducing wastewater systems, as well as energy-efficient heating and cooling. A division of GF, GF Building Flow Solutions – formerly known as Uponor (Uponor Inc. in the U.S., Uponor Ltd. in Canada) and GF Building Technology – has sales companies in 30 countries and production sites in 12 locations across Europe and the Americas.

#LeadingwithWater
www.georgfischer.com
www.uponor.com

Pictures

Reprint free of charge // please note the copyright information //
please provide copy of magazine or a link to the online publication

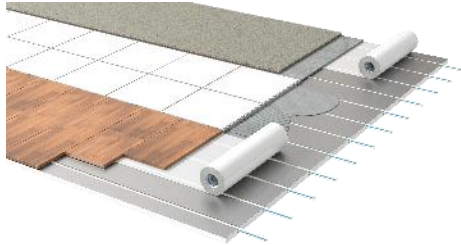
**GF_BFS_Siccus_16**

With Uponor Siccus 16, installers can confidently modernize buildings with a low-height, high-efficiency radiant heating system that simplifies installation while maximizing performance.

Source: GF Building Flow Solutions**GF_BFS_Siccus_16_Ambience**

Design freedom factor: room design without radiators. Uponor Siccus 16 gives planners and building owners more design options in the room: the heating is completely built into the floor so that the interior design does not have to be adapted to the heating system with traditional radiators, which take up space on the walls.

**Source: GF Building Flow Solutions****GF_BFS_Uponor_Siccus_16_Installation**

The Uponor Siccus 16 dry underfloor radiant heating system allows direct flooring on the EPS board, eliminating several steps in installation. This leads to 40 % faster installation and cost-savings.

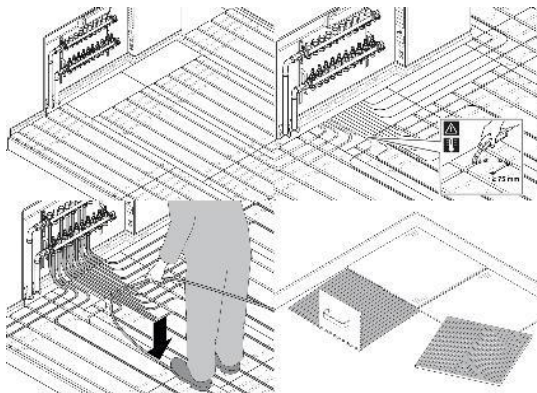
**Source: GF Building Flow Solution**